

# Downtown Knoxville Design Overlay District Certificate of Appropriateness

Name of Applicant: ES&H, INC.

Owner  Contractor  Architect  Engineer  Other

Date Filed: 2/1/2008 Application accepted by: \_\_\_\_\_

Fee Amount: \$30.00 Review Date: \_\_\_\_\_ File Number: 2008-08-DT

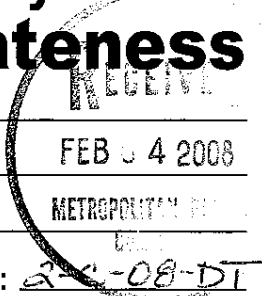

**PRE-APPLICATION CONFERENCE** Date Completed: \_\_\_\_\_

**PROPERTY INFORMATION**

Building or Project Name: FIDELITY BUILDING

Street Address: 502 S. GAY STREET

Tax Identification Number(s):  
62-0222535 (H.T. HARKNEY - LESSEE)  
62-1660972 (WOODSTONE - OWNER)

**PROJECT ARCHITECT/ENGINEER**

PLEASE PRINT Name: (NOT APPLICABLE)

Company: \_\_\_\_\_

Address: \_\_\_\_\_

City: \_\_\_\_\_ State: \_\_\_\_\_ Zip: \_\_\_\_\_

Telephone: \_\_\_\_\_

Fax: \_\_\_\_\_

E-mail: \_\_\_\_\_

**PROPERTY OWNER**

PLEASE PRINT Name: WOODSTONE ENTERPRISES LP

Company: 502 S. GAY ST. SUITE 300

Address: \_\_\_\_\_

City: KNOXVILLE State: TN Zip: 37902

Telephone: (865) 546-1291

Fax: (865) 546-1501

E-mail: MIKE.MORROW@HTHARKNEY.COM

**PROJECT CONTRACTOR**

PLEASE PRINT Name: WILLIAM P. GARIBAY

Company: ES&H, INC.

Address: 10732 DUTCH TOWN ROAD

City: KNOXVILLE State: TN Zip: 37932

Telephone: (865) 671-2374

Fax: (865) 675-6220

E-mail: WGARIBAY@ES&HINC.COM

**ACCOMPANYING MATERIALS**  
Please see the reverse side of this form for a list of information required as part of this application.

**FOR OFFICE USE ONLY**

**PROJECT INFORMATION**

LEVEL 1: \$30  
 Minor Alteration of an Existing Building/Structure  
 Sign

LEVEL 2: \$70  
 Major Alteration of an Existing Building/Structure  
 Addition to an Existing Building/Structure

LEVEL 3: \$100  
 Construction of New Building/Structure

**PROJECT CONTACT**

All application-related correspondence should be directed to:

PLEASE PRINT Name: JOSEPH H HAWK

Company: ES&H, INC.

Address: 10732 DUTCH TOWN ROAD

City: KNOXVILLE State: TN Zip: 37932

Telephone: (865) 803-5577

Fax: (865) 675-6220

E-mail: JHAWK@ES&HINC.COM

NOTE: Payment is due at time of application. Please make check payable to Knoxville Knox County Metropolitan Planning Commission.

# The H.T. Hackney Co. Window Replacement Project

## Project Overview and Method of Accomplishment

### February 1, 2008

1. This scope of work for this project includes replacement of 98 windows at The H.T. Co. 502 South Gay Street building. All windows on Gay Street, Union Avenue (except for 5 windows along bottom of Union Ave.), and State Street sides of building will be replaced with Eagle windows. Execution of window replacement activities will take approximately 6 months from notice to proceed through project completion.
2. ES&H, Inc. will be responsible for overall management of the project including interfacing with The H.T. Hackney Co. designated project manager, coordinating applicable permits with the City of Knoxville and other local, state, and federal agencies, and assuring all work is safely and compliantly completed in strict accordance with the contract scope of work. ES&H, Inc. certainly realizes the importance of cost, schedule, and safety, but also understands that quality is also a key corporate value within The H.T. Hackney Co. ES&H, Inc. will use 1 very reputable, experienced, and qualified subcontractor to support planning and execution of all work activities. Bivens Woodworks out of Maryville, Tennessee has a work force of highly skilled carpenters and laborers with experience in providing quality finish work including installation of windows and doors, construction and installation of custom millwork, and construction and installation of custom window jamb extensions and trim. ES&H, Inc. recently used Bivens Woodworks to build and install all window jamb extensions and interior trim at the Maryville Housing Authority Administration Building Renovation and Addition project. They also constructed the entire fascia and soffit system at this project for a very complicated roof system.
3. ES&H, Inc. will conduct work force training that includes window removal and installation techniques, safety, quality, tenant interaction, facility logistics, and general work expectations.
4. A City of Knoxville Department of Operations & Engineering Temporary Traffic Control Permit is required to control vehicular and pedestrian traffic while working on Gay Street and Union Avenue sides of the building. ES&H, Inc. has interfaced with Tony Vandergriff (City of Knoxville Civil Engineering Division) to more clearly understand the permit application requirements. The attached plan of Gay Street and surrounding areas depicts traffic controls that will be "in play" during execution of all work activities. This plan also shows the proposed location of the trash dumpster.
5. Please be aware that paid parking has been removed along the Union Avenue side of the building and it is now a commercial loading zone. We will use part of the commercial loading zone to stage a dumpster to containerize debris generated as a result of window replacement and exterior restoration activities.

6. ES&H, Inc. assumes an average production rate of 1 window per day installed and trimmed out. Installation includes demolition and off site disposition of the existing windows.
  - Gay Street – 9 arched and 18 rectangular windows (27 windows x 1day/window = 27 days)
  - Union Avenue – 15 arched and 31 rectangular windows (46 windows x 1day/window = 46 days)
  - State Street – 24 arched and 1 rectangular (25 windows x 1day/window = 24 days)
7. Since there is only one elevator in the building, ES&H, Inc. will limit to the extent practical its use during normal working hours, minimizing disruptions to The H.T. Hackney Co. operations and the operations of other tenants in the building. We will be using a combination of roof mounted scaffolding (see Item 12 below for further details) and standard ground up scaffolding to conduct all exterior work activities including lifting and positioning windows so we can bring them into the building through openings at each of the floors. This will eliminate use of the elevator and use of the stairway to move windows throughout the building. The size of the elevator does not allow it to be used to transport some of the windows (window height exceeds elevator height).
8. ES&H, Inc. assumes that jamb extensions, trim wood, and sheetrock returns will need to be installed to finish off all windows on the inside of the building. The windows will be fabricated such that they will fit up the existing brick veneer with only backer rod and silicone caulking required to finish off windows on the outside of the building. There will be no structural modifications or modifications made to the exterior brick veneer as a result of the window replacement activities. ES&H, Inc. assumes that there is a possibility that existing sills, sheetrock returns, drop ceiling grid, and drop ceiling tiles inside the building will have to be replaced.
9. 2x6 or 2x8 pressure treated wood members will be used under windows to minimize modification to existing sills inside the building. The wood members will be flashed with window membrane tape to direct water away from the windows and create a separation between the pressure treated wood and outside steel sills.
10. Prior to demolition of a window, a heavy duty reinforced canvas section (or similar type of safety net structure) will be attached around the perimeter of the window (via tapcons into mortar joints) to catch any demolition debris and prevent anything from falling out the windows onto the streets below. ES&H, Inc. will repair all mortar joints as necessary after installation of the windows. ES&H, Inc. will not attach anything to the building's precast concrete elements.
11. ES&H, Inc. assumes flat pine paint grade (not stain grade) wood jamb extensions, trim, and sills will be used as required to finish all windows on the inside of the building. ES&H, Inc. assumes The H.T. Hackney Co. maintenance personnel and other building tenants will be responsible for final painting of jamb extensions, trim, sills, sheetrock returns, etc. to match existing décor.

12. A counterweight scaffolding system will be used to support workers, material, and equipment during exterior restoration activities. This system is supported from the roof of the building with counterweights. A motorized pulley and cable system raises and lowers the scaffolding as needed to safely support all exterior restoration activities. ES&H, Inc. pricing assumes minor temporary modifications to electrical system to support operation of the motorized pulley and cable system.
13. Due to the vehicular and pedestrian traffic adjacent to the work areas, ES&H, Inc. health and safety officer will conduct periodic assessments during the period of performance of the project to assure personal protective equipment and engineering and administrative controls are being properly integrated into all work activities to assure compliance with applicable ES&H, Inc., OSHA, Life Safety Code, and The H.T. Hackney Co. safety requirements and expectations.

# TRAFFIC CONTROL PLAN

④ DUMPSTER WILL BE PLACED AT LOCATION ON UNION AVE. SUCH THAT RIGHT TURNS ON TO UNION AVE. ARE NOT IMPACTED AS VISIBILITY IS NOT IMPAIRED. TRAFFIC CONES OR BARRIERS WILL BE PLACED AROUND DUMPSTER.



- ① PEDESTRIAN TOWER ALONG ENTIRE GAY STREET SIDE OF BUILDING
- ② "CAUTION WORK AHEAD" SIGN - INTERSECTION OF GAY ST. & EAST UNION AVE.
- ③ "SIDEWALK CLOSED USE OTHER SIDE" SIGN - INTERSECTION OF UNION AVE. AND STATE ST.
- ... TRAFFIC BARRIERS WILL BE USED TO BLOCK OFF RIGHT NORTH BOUND LANE OF GAY ST. DURING WORK ON GAY STREET. BARRIERS WILL BE TAPERED INTO SIDEWALK GOING SOUTH BOUND TO ALLOW 2 LANES + TRAFFIC TO MERGE INTO 1 LANE.

Existing Window  
Gay Street 2<sup>nd</sup> Floor  
(to be replaced with G Type)

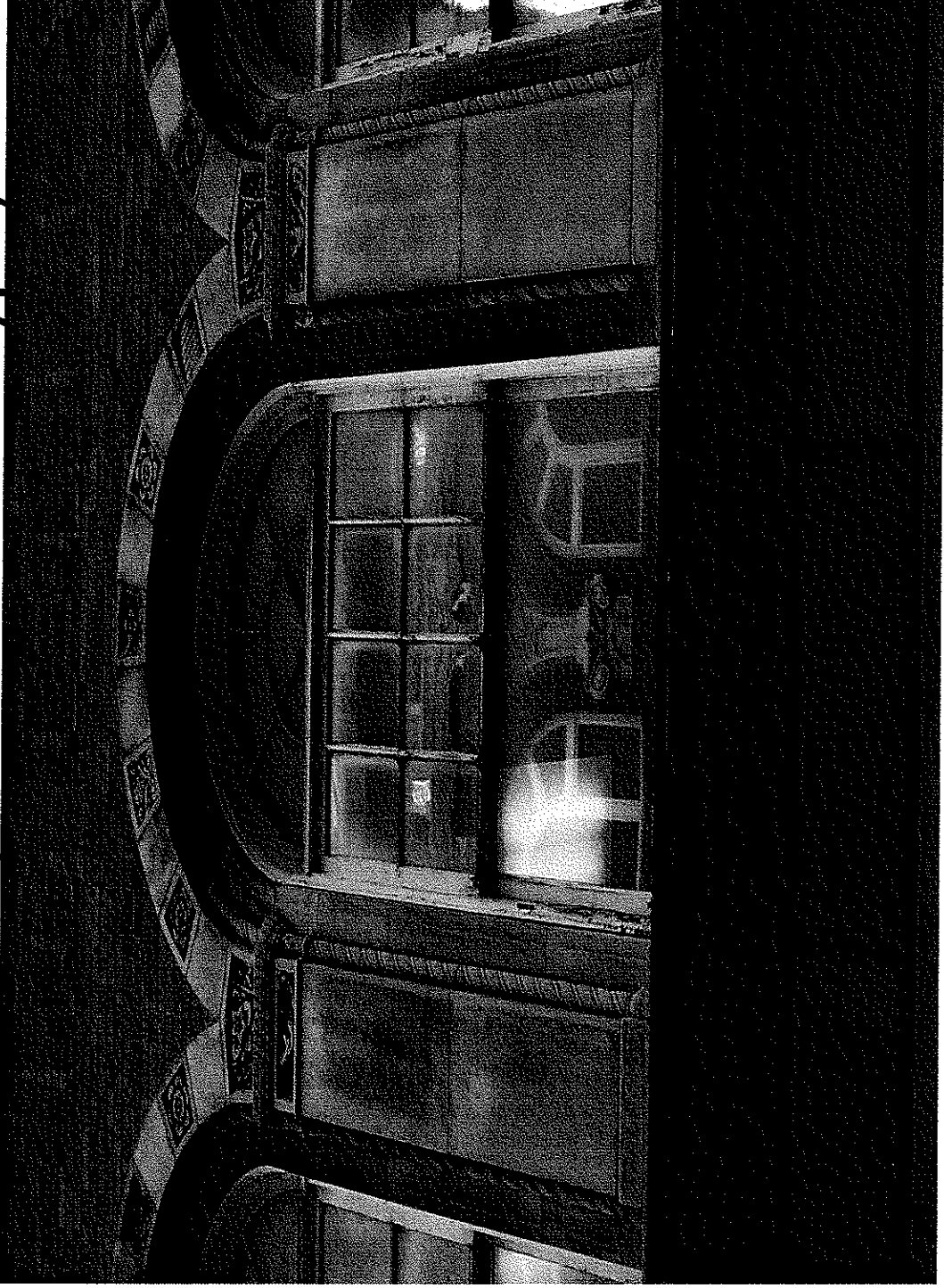

# New G Type Window Gay Street 2<sup>nd</sup> Floor



Existing Window  
Union Ave 2<sup>nd</sup> Floor  
(to be replaced with C Type)

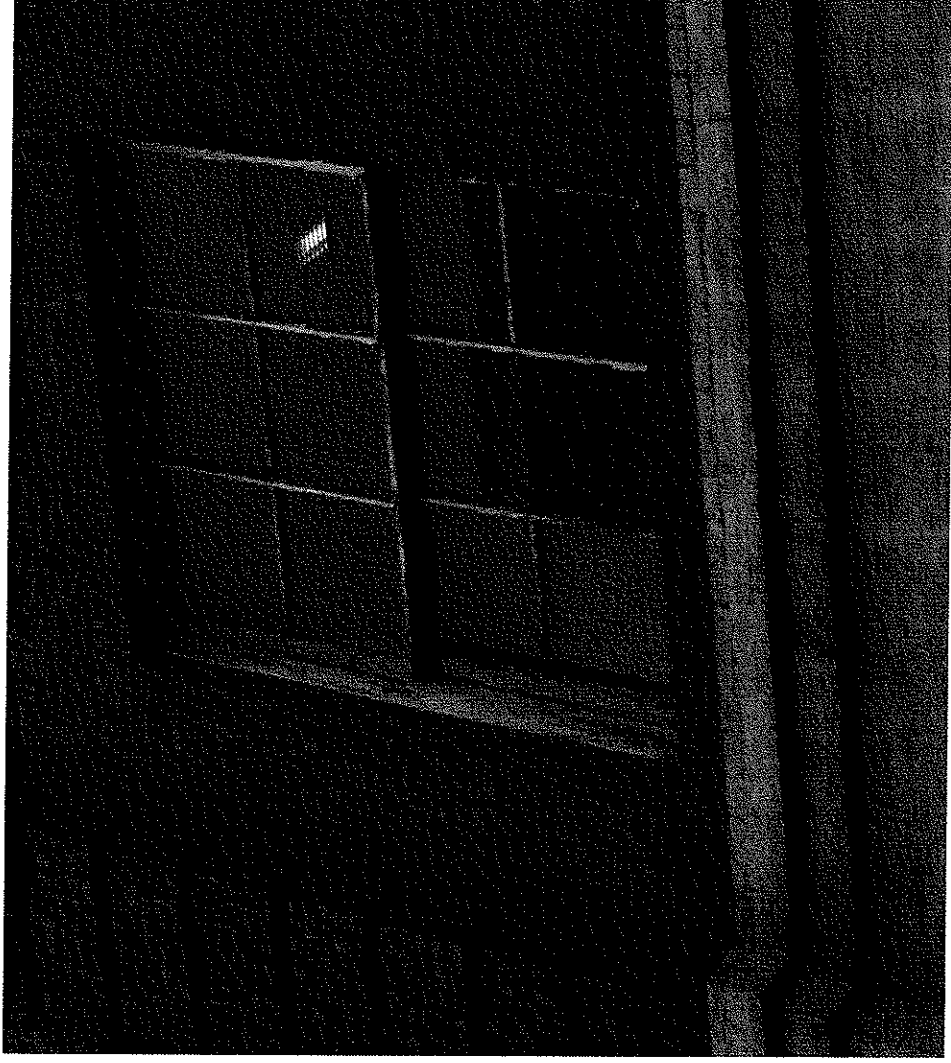



# New C Type Window Union Ave 2<sup>nd</sup> Floor

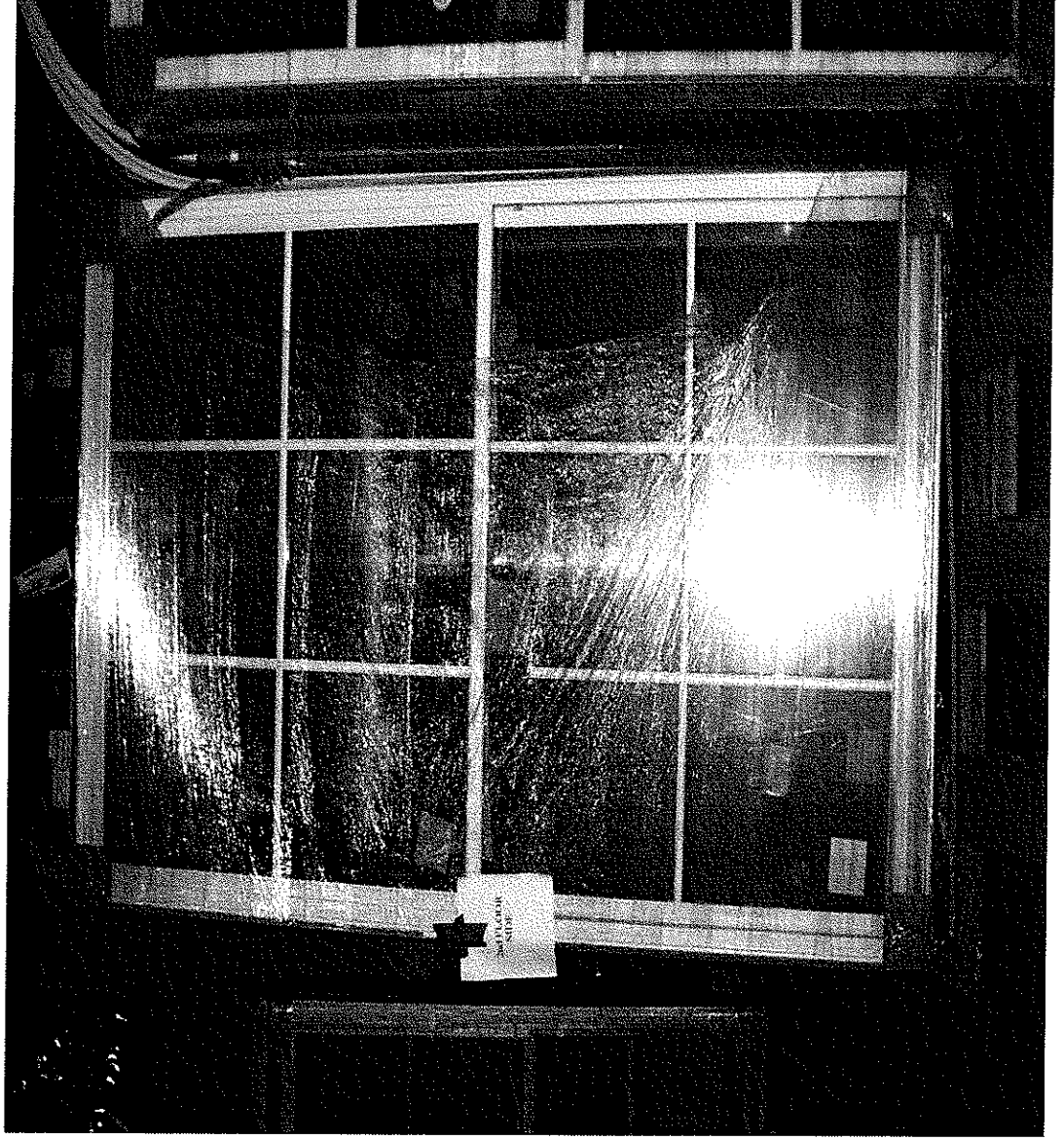

Existing Window  
Union Ave 1<sup>st</sup> Floor  
(to be replaced with N Type)

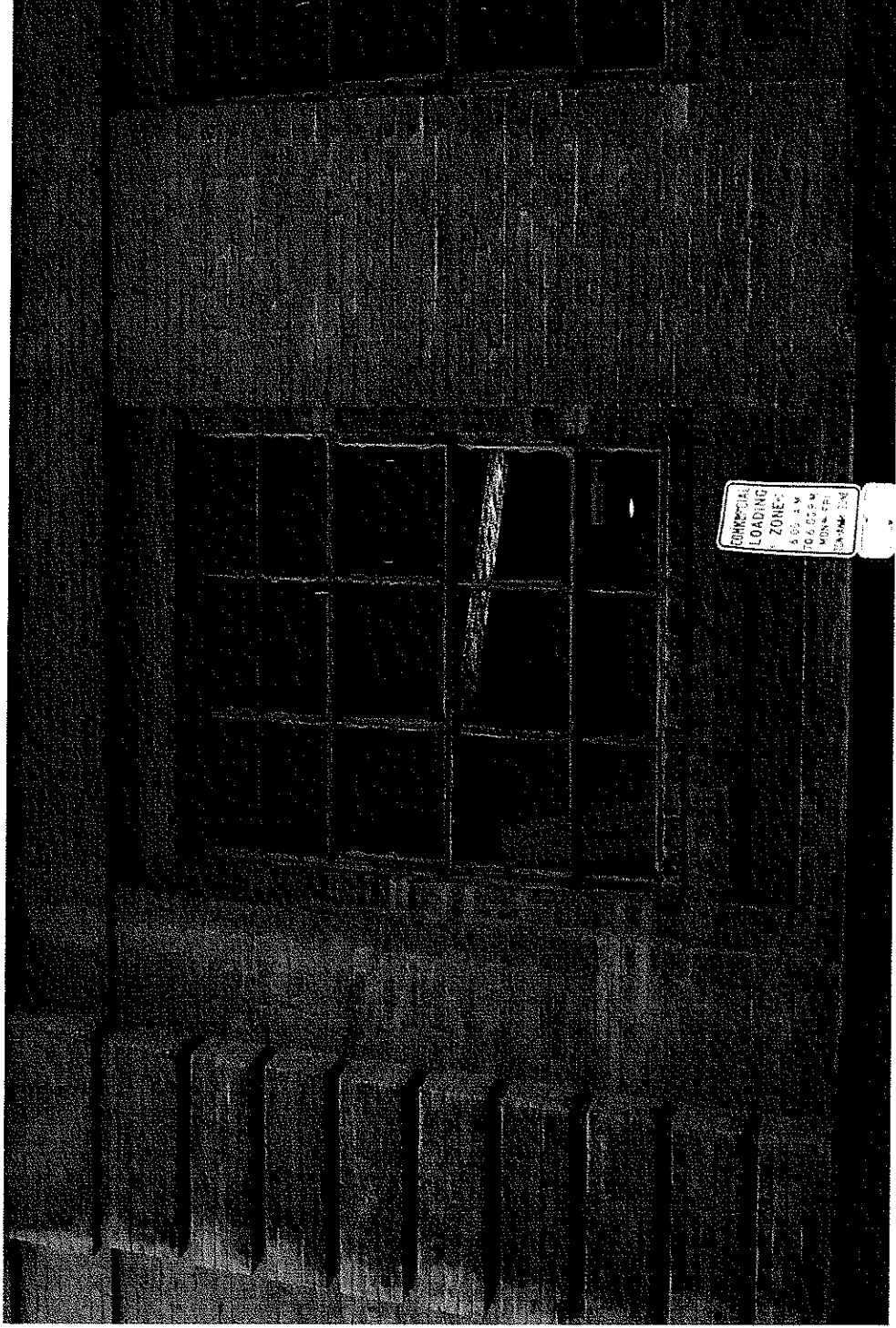

# New N Type Window Union Ave 1<sup>st</sup> Floor



*Das F*  
New Type Window  
Gay Street 2<sup>nd</sup> Floor



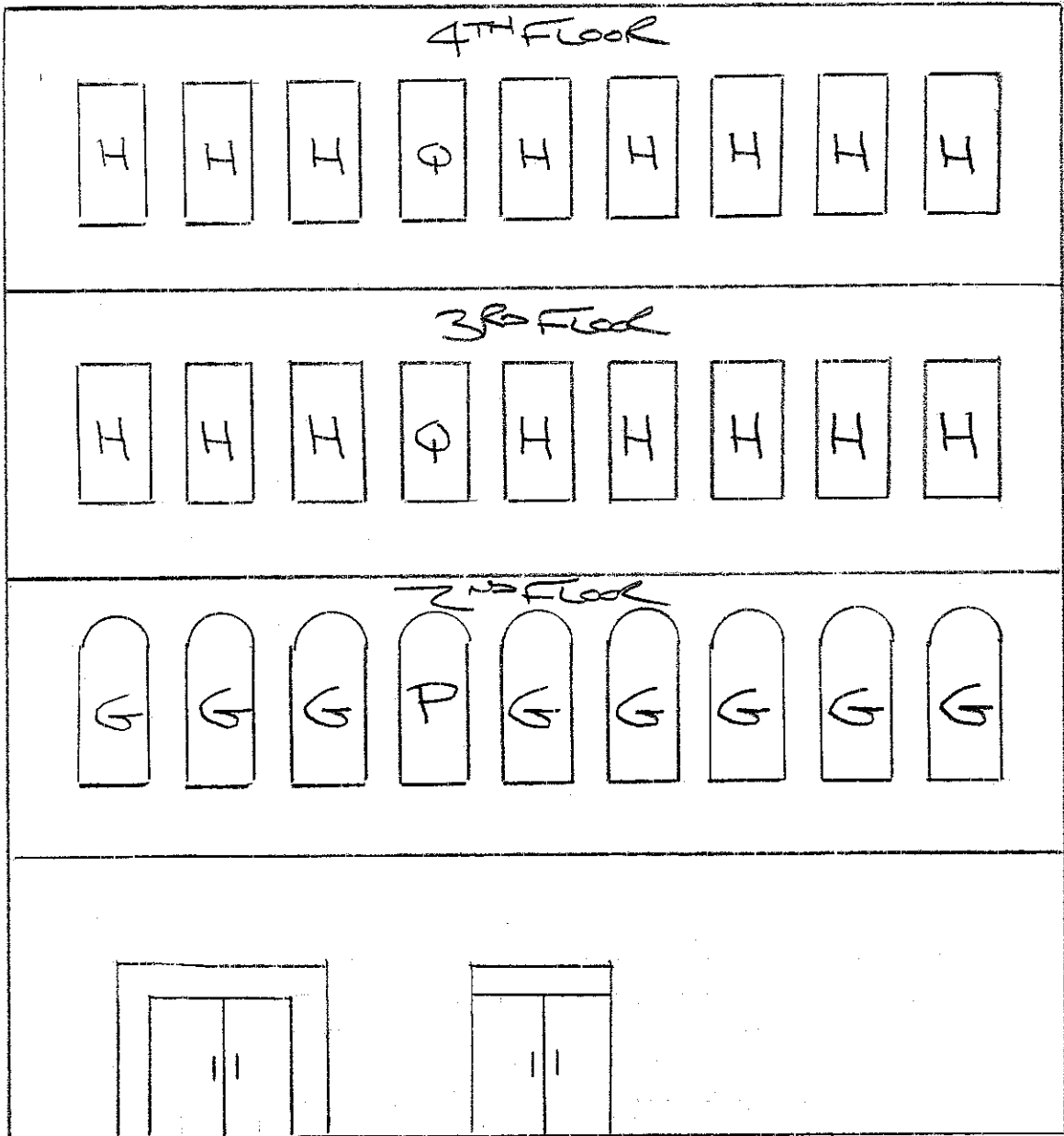

THE H.T. HACKNEY CO.  
 502 SOUTH GAY STREET BUILDING  
 GAY STREET ELEVATION VIEW

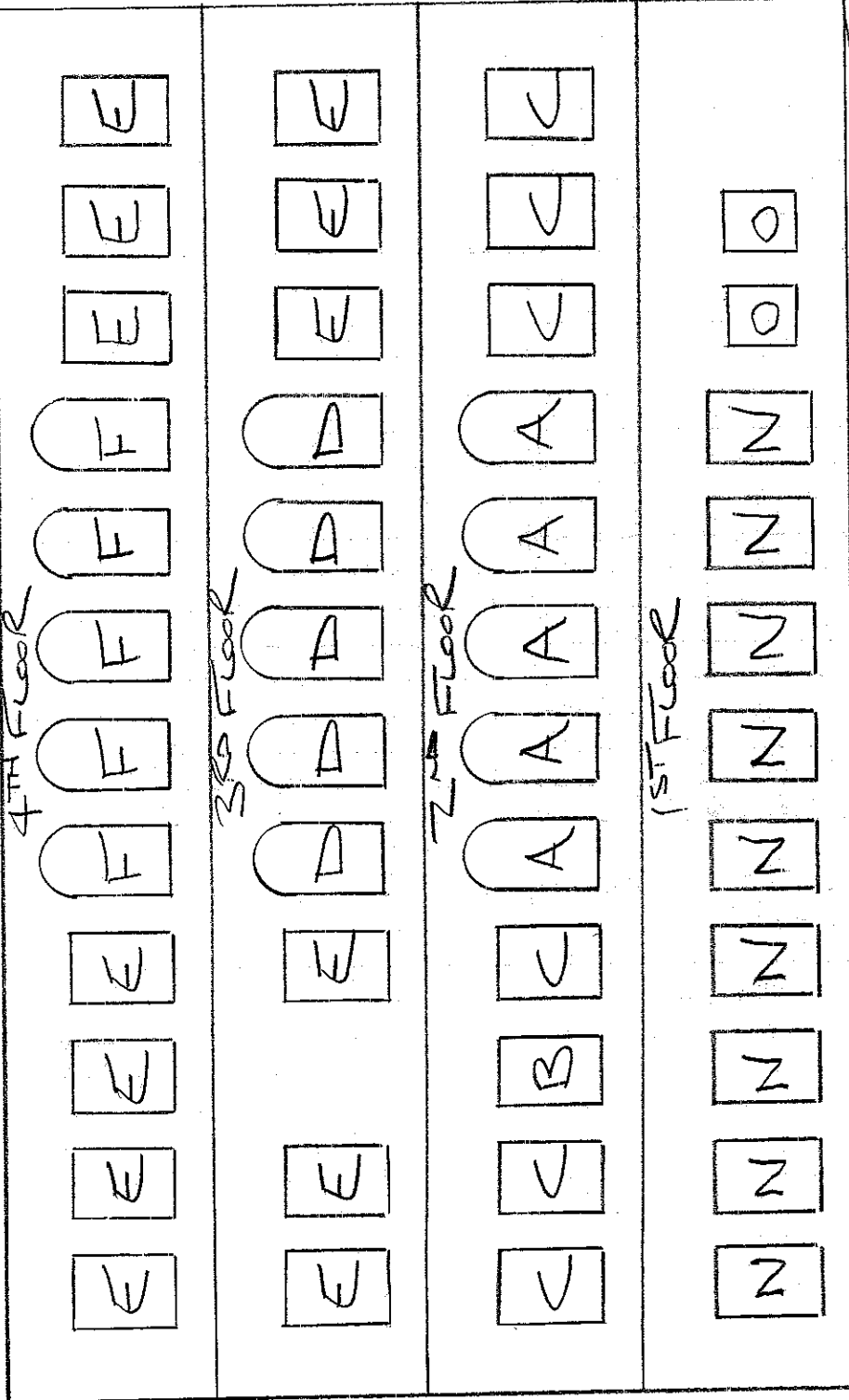

NOT INCLUDED  
 2 SIDES OF WORK

THE H.T. HACKNEY CO.  
 502 SOUTH GAY STREET BUILDING  
 UNION AVENUE ELEVATION VIEW

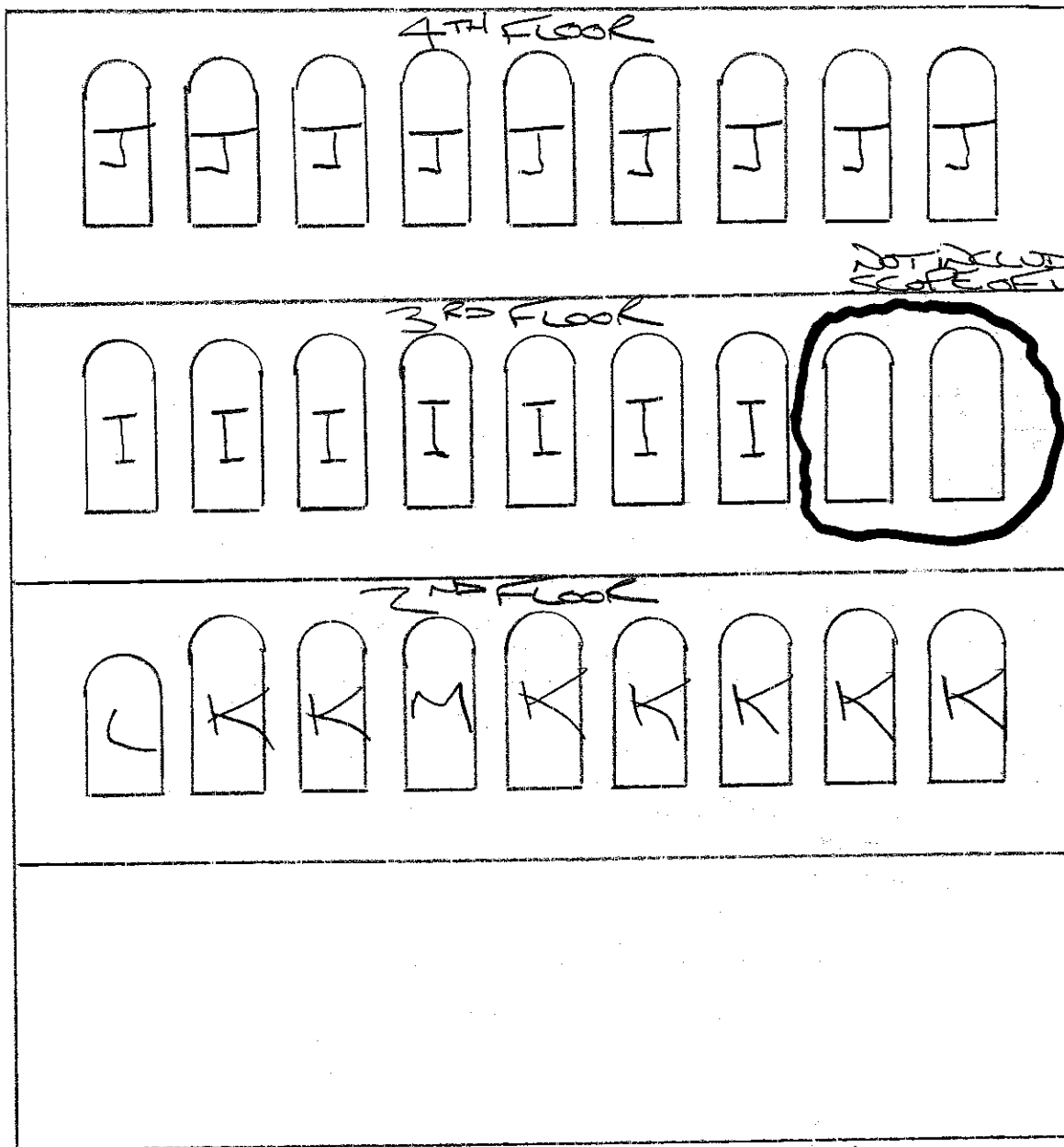

THE H.T. HACKNEY CO.  
 502 SOUTH GAY STREET BUILDING  
 STATE STREET ELEVATION VIEW

**Builder Copy - Ship To**

Quote # 370610

Hackney Replacement

1/9/2008



FAX

Quote 370610  
Job Tag H.T Hackney

Bid By Roger Fletcher

Company  
H T Hackney Co  
1209 Hilton Road

Job Site  
Hackney Replacement

JobPhone

Knoxville TN 37921  
(865)482-4991 FAX

Line	Item Number	UM	Qty	Quote #
100	CDHGCSTM	EA	5	370610

**Special CLAD DH CUSTOM PRODUCT**

1 BOT - 1 TOP, 4 9/16" WALL, NO STEP JAMB, JAMB ALL SIDES, FULL LENGTH MULL. NO NAILFIN, NO BRICKMOLD. LINEN - RES, LINEN - RES COLONIAL STOPS, DRIP MULL

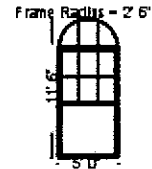

CLAD MONUMENTAL TALON DHG, 5', 0, 0, 9', 0, 0 MONMNTL SINGLEHUNG-NO BOT SASH, BEIGE JAMBLINER. MDL, LINEN - RES. 7/8" BARS, 3 LITES WIDE, 2 LITES HIGH 2 LOCKS, 24" LIMITED TRAVEL. BRONZE HDWE, LOW E. B & T

CLAD 1/2 CIRCLE, 5026, MDL, LINEN - RES, 7/8" BARS, SPECIAL PTRN, 3 LITES, DOUBLE HUNG FRAME PROFILE 1/8 TEMP LOW E

Rough Opening: 5' 0 1/2" X 11' 6 1/2"



Side 2nd Floor  
bronze keyed sash lock applied.  
gd

TO BE SURFACE MOUNTED AS THIRD LOCK BETWEEN STANDARD LOCKS

Line	Item Number	UM	Qty	Quote #
200	605482	EA	5	370610

605482 158 TALON DH BOT SASH 5-0 X 9-0, 7/8MDL 2HI-3WD, NOLFT PREP, BRZHDWE, W/SURFACE MOUNT KEYED LOCK IN CENTER, NL

Side 2nd Floor Bottom Sash



Quote # 370610

Hackney Replacement

Line	Item Number	UM	Qty	Quote #
300	CDHGCSTM	EA	1	370610

**Special CLAD DH CUSTOM PRODUCT**

1 WIDE UNIT 4 9/16" WALL NO STEP JAMB, NO NAILFIN, NO BRICKMOLD, LINEN - RES LINEN - RES COLONIAL STOPS

CLAD MONUMENTAL TALON DHG, 3', 2" 0 7', 7" 1/2', MONUMENTAL SINGLE HUNG BEIGE JAMBLINER, MDL, LINEN - RES 7/8" BARS, 2 LITES WIDE, 2 LITES HIGH, MDL, LINEN - RES, 7/8" BARS, 2 LITES WIDE, 2 LITES HIGH, 2 LOCKS, NO LIFTS - NO LIFT PREP, 24" LIMITED TRAVEL BRONZE HDWE LOW E, LOW E. B & T



Rough Opening: 3' 2 1/2" X 7' 8"



Side 2nd Floor

bronze keyed sash lock applied  
gd

TO BE SURFACE MOUNTED AS THIRD LOCK BETWEEN STANDARD LOCKS

Line	Item Number	UM	Qty	Quote #
400	CDHGCSTM	EA	6	370610

**Special CLAD DH CUSTOM PRODUCT**

1 WIDE UNIT 4 9/16" WALL, NO STEP JAMB, NO NAILFIN, NO BRICKMOLD, LINEN - RES, LINEN - RES. COLONIAL STOPS

CLAD MONUMENTAL TALON DHG, 5', 0, 0, 8' 5" 1/2', MONUMENTAL SINGLE HUNG BEIGE JAMBLINER, MDL LINEN - RES, 7/8" BARS, 3 LITES WIDE, 2 LITES HIGH, MDL, LINEN - RES 7/8" BARS, 3 LITES WIDE, 2 LITES HIGH, 2 LOCKS, NO LIFTS - NO LIFT PREP, 24" LIMITED TRAVEL BRONZE HDWE, TEMP LOW E, TEMP LOW E. B & T

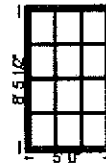

Rough Opening: 5' 0 1/2" X 8' 6"



Side 2nd Floor

bronze keyed sash lock applied  
gd

TO BE SURFACE MOUNTED AS THIRD LOCK BETWEEN STANDARD LOCKS  
SUBJECT TO APPROVED DRAWING

Quote # 370610

Hackney Replacement

Line	Item Number	UM	Qty	Quote #
500	CDHGCSTM	EA	5	370610

Special CLAD DH CUSTOM PRODUCT

1 BOT - 1 TOP, 4 9/16" WALL, NO STEP JAMB, JAMB ALL SIDES, FULL LENGTH MULL. NO NAILFIN, NO BRICKMOLD, LINEN - RES, LINEN - RES, COLONIAL STOPS, DRIP MULL

CLAD MONUMENTAL TALON DHG, 5', 0, 0, 7', 1", 1/2", MONUMENTAL SINGLE HUNG BEIGE JAMBLINER, MDL, LINEN - RES, 7/8" BARS, 3 LITES WIDE, 2 LITES HIGH, MDL, LINEN - RES 7/8" BARS 3 LITES WIDE, 2 LITES HIGH 2 LOCKS, NO LIFTS - NO LIFT PREP, BRONZE HDWE LOW E LOW E, B & T

CLAD 1/2 CIRCLE, 5026, MDL, LINEN - RES, 7/8" BARS, SPECIAL PTRN 3 LITES, DOUBLE HUNG FRAME PROFILE 1/B TEMP LOW E

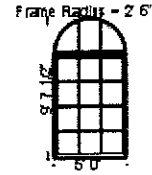

Rough Opening: 5' 0 1/2" X 9' 8"

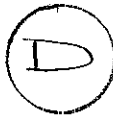

Side 3rd Floor

bronze keyed sash lock applied  
gd

TO BE SURFACE MOUNTED AS THIRD LOCK BETWEEN STANDARD LOCKS  
SUBJECT TO APPROVED DRAWING

Line	Item Number	UM	Qty	Quote #
600	CDHGCSTM	EA	13	370610

Special CLAD DH CUSTOM PRODUCT

1 WIDE UNIT 4 9/16" WALL NO STEP JAMB, NO NAILFIN, NO BRICKMOLD, LINEN - RES LINEN - RES COLONIAL STOPS

CLAD MONUMENTAL TALON DHG, 5', 0, 0, 7', 10", 1/2", MONUMENTAL SINGLE HUNG, BEIGE JAMBLINER, MDL, LINEN - RES, 7/8" BARS, 3 LITES WIDE 2 LITES HIGH MDL, LINEN - RES, 7/8" BARS, 3 LITES WIDE, 2 LITES HIGH, 2 LOCKS NO LIFTS - NO LIFT PREP 24" LIMITED TRAVEL, BRONZE HDWE LOW E, LOW E B & T

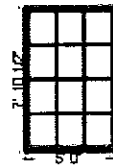

Rough Opening: 5' 0 1/2" X 7' 11"



Side 3rd and 4th Floors

bronze keyed sash lock applied  
gd

TO BE SURFACE MOUNTED AS THIRD LOCK BETWEEN STANDARD LOCKS

Line	Item Number	UM	Qty	Quote #
700	CDHGCSTM	EA	5	370610

**Special CLAD DH CUSTOM PRODUCT**

1 BOT - 1 TOP 4 9/16" WALL, NO STEP JAMB, JAMB ALL SIDES, FULL LENGTH MULL, NO NAILFIN, NO BRICKMOLD, LINEN - RES LINEN - RES COLONIAL STOPS DRIP MULL

CLAD MONUMENTAL TALON DHG, 5', 0, 0, 6', 8" 1/2", MONUMENTAL SINGLE HUNG, BEIGE JAMBLINER, MDL, LINEN - RES 7/8" BARS, 3 LITES WIDE, 2 LITES HIGH, MDL, LINEN - RES, 7/8" BARS 3 LITES WIDE, 2 LITES HIGH 2 LOCKS. NO LIFTS - NO LIFT PREP, BRONZE HDWE, LOW E, LOW E, B & T

CLAD 1/2 CIRCLE, 5026, MDL, LINEN - RES, 7/8" BARS, SPECIAL PTRN, 3 LITES, DOUBLE HUNG FRAME PROFILE, 1/8 TEMP LOW E

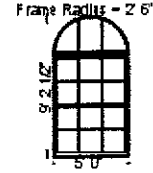

Rough Opening: 5' 0 1/2" X 9' 3"



Side 4th Floor

bronze keyed sash lock applied  
gd

TO BE SURFACE MOUNTED AS THIRD LOCK BETWEEN STANDARD LOCKS  
SUBJECT TO APPROVED DRAWING

Line	Item Number	UM	Qty	Quote #
800	CDHGCT	EA	8	370610

**Special CLAD DOUBLE HUNG/CIRCLE TOP**

1 BOT - 1 TOP, 4 9/16" WALL, JAMB ALL SIDES, FULL LENGTH MULL NO NAILFIN NO BRICKMOLD, LINEN - RES, BEIGE JAMBLINER, COLONIAL STOPS DRIP MULL

CLAD MONUMENTAL TALON DHG, 4', 10" 0 7', 9' 1/2", MONUMENTAL SINGLE HUNG, MDL, LINEN - RES, 7/8" BARS, 4 LITES WIDE 2 LITES HIGH, MDL, LINEN - RES, 7/8" BARS, 4 LITES WIDE 2 LITES HIGH, 2 LOCKS, NO LIFTS - NO LIFT PREP BRONZE HDWE, LOW E, LOW E, B & T

CLAD 1/2 CIRCLE, 4', 10", 0, MDL, LINEN - RES, 7/8" BARS SPECIAL PTRN, DOUBLE HUNG FRAME PROFILE, TEMP LOW E

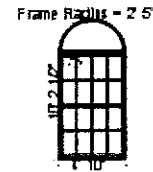

Rough Opening: 4' 10 1/2" X 10' 3"



Front Radius Windows 2nd Floor

Radius MDL-(1) hoop with (3) spokes, center spoke non-intersecting-((7) total lites  
bronze keyed sash lock applied  
gd

SUBJECT TO APPROVED DRAWING

Quote # 370610

Hackney Replacement

Line	Item Number	UM	Qty	Quote #
900	16305	EA	1	370610

16305 CUSTOM/FIXTURE CHARGE

Front Radius Wndw 2nd Floor

Line	Item Number	UM	Qty	Quote #
1000	CDHGCSTM	EA	16	370610

Special CLAD DH CUSTOM PRODUCT

1 WIDE UNIT, 4 9/16" WALL, NO STEP JAMB, NO NAILFIN, NO BRICKMOLD LINEN - RES LINEN - RES, COLONIAL STOPS

CLAD MONUMENTAL TALON DHG, 4', 6", 0, 8' 2", 1/2", MONUMENTAL SINGLE HUNG, BEIGE JAMBLINER, 2 LOCKS NO LIFTS - NO LIFT PREP 24' LIMITED TRAVEL BRONZE HDWE LOW E. LOW E. B & T



Rough Opening: 4' 6 1/2" X 8' 3"



Front 3rd and 4th Floor

bronze keyed sash lock applied  
gd

TO BE SURFACE MOUNTED AS THIRD LOCK BETWEEN STANDARD LOCKS

Quote # 370610

Hackney Replacement

Line	Item Number	UM	Qty	Quote #
1100	CDHGCSTM	EA	7	370610

**Special CLAD DH CUSTOM PRODUCT**

1 BOT - 1 TOP 4 9/16" WALL NO STEP JAMB, JAMB ALL SIDES, FULL LENGTH MULL, NO NAILFIN, NO BRICKMOLD, LINEN - RES. LINEN - RES, COLONIAL STOPS DRIP MULL

CLAD MONUMENTAL TALON DHG, 5', 0, 0, 7', 3" 0, MONUMENTAL SINGLE HUNG BEIGE JAMBLINER, MDL. LINEN - RES 7/8" BARS, 4 LITES WIDE, 3 LITES HIGH, MDL, LINEN - RES, 7/8" BARS 4 LITES WIDE, 3 LITES HIGH 2 LOCKS, NO LIFTS - NO LIFT PREP BRONZE HDWE LOW E, LOW E B & T

CLAD 1/2 CIRCLE, 5026, MDL, LINEN - RES, 7/8" BARS, SPECIAL PTRN 8 LITES DOUBLE HUNG FRAME PROFILE 1/B TEMP LOW E

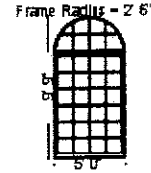

Rough Opening: 5' 0 1/2" X 9' 9 1/2"



Rear 3rd Floor

bronze keyed sash lock applied  
gd

TO BE SURFACE MOUNTED AS THIRD LOCK BETWEEN STANDARD LOCKS  
SUBJECT TO APPROVED DRAWING

Line	Item Number	UM	Qty	Quote #
1200	CDHGCSTM	EA	9	370610

**Special CLAD DH CUSTOM PRODUCT**

1 BOT - 1 TOP 4 9/16" WALL NO STEP JAMB, JAMB ALL SIDES, FULL LENGTH MULL, NO NAILFIN, NO BRICKMOLD LINEN - RES. LINEN - RES. COLONIAL STOPS DRIP MULL

CLAD MONUMENTAL TALON DHG, 5', 0, 0, 6', 9" 1/2", MONUMENTAL SINGLE HUNG, BEIGE JAMBLINER, MDL. LINEN - RES 7/8" BARS, 4 LITES WIDE, 3 LITES HIGH, MDL, LINEN - RES, 7/8" BARS 4 LITES WIDE, 3 LITES HIGH 2 LOCKS, NO LIFTS - NO LIFT PREP BRONZE HDWE LOW E, LOW E B & T

CLAD 1/2 CIRCLE, 5026, MDL, LINEN - RES, 7/8" BARS, SPECIAL PTRN, 8 LITES DOUBLE HUNG FRAME PROFILE 1/B TEMP LOW E

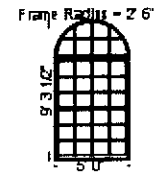

Rough Opening: 5' 0 1/2" X 9' 4"



Rear 4th Floor

bronze keyed sash lock applied  
gd

TO BE SURFACE MOUNTED AS THIRD LOCK BETWEEN STANDARD LOCKS  
SUBJECT TO APPROVED DRAWING

Line	Item Number	UM	Qty	Quote #
1300	CDHGCSTM	EA	7	370610

**Special CLAD DH CUSTOM PRODUCT**

1 BOT - 1 TOP 4 9/16" WALL NO STEP JAMB, JAMB ALL SIDES, FULL LENGTH MULL, NO NAILFIN, NO BRICKMOLD. LINEN - RES LINEN - RES COLONIAL STOPS DRIP MULL

CLAD MONUMENTAL TALON DHG, 5' 0, 0, 8', 10", 1/2". MONMNTL SINGLEHUNG-NO BOT SASH, BEIGE JAMBLINER, MDL LINEN - RES. 7/8" BARS, 4 LITES WIDE, 3 LITES HIGH 2 LOCKS, 24" LIMITED TRAVEL, BRONZE HDWE, LOW E. B & T

CLAD 1/2 CIRCLE, 5026, MDL, LINEN - RES, 7/8" BARS, SPECIAL PTRN, 8 LITES. DOUBLE HUNG FRAME PROFILE 1/8 TEMP LOW E

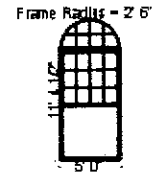

Rough Opening: 5' 0 1/2" X 11' 5"



Rear 2nd Floor

bronze keyed sash lock applied  
gd

TO BE SURFACE MOUNTED AS THIRD LOCK BETWEEN STANDARD LOCKS  
SUBJECT TO APPROVED DRAWING

Line	Item Number	UM	Qty	Quote #
1400	605483	EA	7	370610

605483 158 TALON DH BOT SASH 5-0 X 8- 10 1/2, 7/8MDL 3HI-4WD, NOLFT PREP, BRZHDW W/SURFACE MOUNT KEYED LOCK IN CENTER, NL

Rear 2nd Floor Bottom Sash

Line	Item Number	UM	Qty	Quote #
1500	CAUXCT	EA	1	370610

**CLAD AUXILIARY/GEO/CIRCLE TOP**

1 BOT - 1 TOP 4 9/16" WALL 1 PIECE DH STEP JAMB, JAMB ALL SIDES, FULL LENGTH MULL, NO NAILFIN NO BRICKMOLD LINEN - RES COLONIAL STOPS, DRIP MULL

CLAD AUXILIARY, 5', 0, 0, 4', 6", 0, MDL, LINEN - RES, 7/8" BARS, 4 LITES WIDE 3 LITES HIGH DOUBLE HUNG FRAME PROFILE, LOW E

CLAD 1/2 CIRCLE, 5026 MDL, LINEN - RES, 7/8" BARS, 4 LITES WIDE, 2 LITES HIGH DOUBLE HUNG FRAME PROFILE 1/8 TEMP LOW E

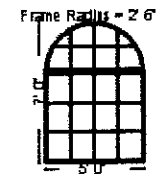

Rough Opening: 5' 0 1/2" X 7' 0 1/2"



Rear 2nd Floor at AC Unit

Quote # 370610

Hackney Replacement

Line	Item Number	UM	Qty	Quote #
1600	CDHGCSTM	EA	1	370610

**Special CLAD DH CUSTOM PRODUCT**

1 BOT - 1 TOP, 4 9/16" WALL, NO STEP JAMB, JAMB ALL SIDES, FULL LENGTH MULL, NO NAILFIN, NO BRICKMOLD, LINEN - RES, LINEN - RES, COLONIAL STOPS, DRIP MULL

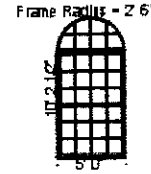

CLAD MONUMENTAL TALON DHG, 5', 0, 0, 7', 8' 1/2", MONUMENTAL SINGLE HUNG, BEIGE JAMBLINER, MDL. LINEN - RES, 7/8" BARS, 4 LITES WIDE, 3 LITES HIGH, MDL. LINEN - RES, 7/8" BARS, 4 LITES WIDE, 3 LITES HIGH, 2 LOCKS NO LIFTS - NO LIFT PREP, BRONZE HDWE LOW E LOW E, B & T

CLAD 1/2 CIRCLE, 5026, MDL, LINEN - RES, 7/8" BARS, SPECIAL PTRN 8 LITES. DOUBLE HUNG FRAME PROFILE 1/B TEMP LOW E

Rough Opening: 5' 0 1/2" X 10' 3"



Rear 2nd Floor

bronze keyed sash lock applied  
gd

TO BE SURFACE MOUNTED AS THIRD LOCK BETWEEN STANDARD LOCKS  
SUBJECT TO APPROVED DRAWING

Line	Item Number	UM	Qty	Quote #
1700	3593	EA	4704	370610

3593 #8 X 1 PPHWS TEKS SCREW MULT

Line	Item Number	UM	Qty	Quote #
1800	67496	EA	1176	370610

67496 12" INSTALLATION STRAP GLV STL .035 X 1.750 X 12.000  
MULT

Line	Item Number	UM	Qty	Quote #
1900	33736	EA	4704	370610

33736 #8 X 3/4 PPHWS TYPE A S.S. MULT

Line	Item Number	UM	Qty	Quote #
2000	LEXMULBLK	EA	2	370610

LEXMULBLK LEXAN MULLING BLOCK 1"X2"X12" MATERIAL IS UHMW MULT

Quote # 370610

Hackney Replacement

Line	Item Number	UM	Qty	Quote #
2100	88758	EA	37	370610
88758 158 5" FRAME EXPANDER 12-0 EWD-112 MULT				

Line	Item Number	UM	Qty	Quote #
2200	CDHGCSTM	EA	9	370610
Special CLAD DH CUSTOM PRODUCT				
1 WIDE UNIT 4 9/16" WALL NO STEP JAMB, NO NAILFIN, NO BRICKMOLD, LINEN - RES LINEN - RES COLONIAL STOPS				

CLAD MONUMENTAL TALON DHG, 4' 6", 0, 9', 10", 1/2" MONMNTL SINGLEHUNG-NO BOT SASH, BEIGE JAMBLINER. MDL, LINEN - RES 7/8" BARS, 3 LITES WIDE 2 LITES HIGH, 2 LOCKS. 24" LIMITED TRAVEL, BRONZE HDWE LOW E, B & T

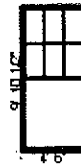

Rough Opening: 4' 6 1/2" X 9' 11"



1st Floor Side

bronze keyed sash lock applied  
gd

TO BE SURFACE MOUNTED AS THIRD LOCK BETWEEN STANDARD LOCKS

Line	Item Number	UM	Qty	Quote #
2300	605484	EA	9	370610
605484 158 TALON DH BOT SASH 4-6 X 9- 10 1/2, 7/8MDL 2HI-3WD,NOLFT PREP, BRZHDW W/SURFACE MOUNT KEYED LOCK IN CENTER, TN				
1st Floor Side Bottom Sash				



Quote # 370610

Hackney Replacement

Line	Item Number	UM	Qty	Quote #
2400	CDHGCSTM	EA	2	370610

**Special CLAD DH CUSTOM PRODUCT**

1 WIDE UNIT, 4 9/16" WALL. NO STEP JAMB, NO NAILFIN, NO BRICKMOLD LINEN - RES LINEN - RES, COLONIAL STOPS

CLAD MONUMENTAL TALON DHG, 3, 6", 0, 6', 4", 1/2", MONUMENTAL SINGLE HUNG BEIGE JAMBLINER, MDL LINEN - RES, 7/8" BARS, 2 LITES WIDE, 2 LITES HIGH, MDL LINEN - RES 7/8" BARS, 2 LITES WIDE, 2 LITES HIGH, 2 LOCKS, NO LIFTS - NO LIFT PREP, 24" LIMITED TRAVEL, BRONZE HDWE LOW E LOW E, B & T

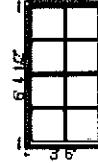

Rough Opening: 3' 6 1/2" X 6' 5"



1st Floor Side

bronze keyed sash lock applied  
gd

TO BE SURFACE MOUNTED AS THIRD LOCK BETWEEN STANDARD LOCKS

Line	Item Number	UM	Qty	Quote #
2500	CDHGCT	EA	1	370610

**Special CLAD DOUBLE HUNG/CIRCLE TOP**

1 BOT - 1 TOP, 4 9/16" WALL, JAMB ALL SIDES FULL LENGTH MULL NO NAILFIN NO BRICKMOLD, LINEN - RES, LINEN - RES, BEIGE JAMBLINER, COLONIAL STOPS DRIP MULL

CLAD MONUMENTAL TALON DHG, 4', 10", 0, 7', 9" 1/2". MONUMENTAL SINGLE HUNG, MDL LINEN - RES, 7/8" BARS, 4 LITES WIDE 2 LITES HIGH, MDL LINEN - RES, 7/8" BARS, 4 LITES WIDE 2 LITES HIGH, 2 LOCKS, NO LIFTS - NO LIFT PREP BRONZE HDWE TEMP LOW E TEMP LOW E, B & T

Frame Radius = 2' 5"



Rough Opening: 4' 10 1/2" X 10' 3"



Front Radius TEMPERED Window 2nd Floor

Radius MDL-(1) hoop with (3) spokes center spoke non-intersecting-((7) total lites  
bronze keyed sash lock applied  
gd

SUBJECT TO APPROVED DRAWING

Quote # 370610

Hackney Replacement

Line	Item Number	UM	Qty	Quote #
2600	CDHGCSTM	EA	2	370610

**Special CLAD DH CUSTOM PRODUCT**

1 WIDE UNIT, 4 9/16" WALL, NO STEP JAMB, NO NAILFIN, NO BRICKMOLD LINEN - RES LINEN - RES COLONIAL STOPS

CLAD MONUMENTAL TALON DHG, 4' 6", 0, 8 2", 1/2", MONUMENTAL SINGLE HUNG, BEIGE JAMBLINER, 2 LOCKS NO LIFTS - NO LIFT PREP, 24" LIMITED TRAVEL, BRONZE HDWE, TEMP LOW E TEMP LOW E B & T

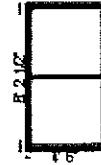

Rough Opening: 4' 6 1/2" X 8' 3"

Front 3rd and 4th Floor TEMPERED  
bronze keyed sash lock applied  
gd

TO BE SURFACE MOUNTED AS THIRD LOCK BETWEEN STANDARD LOCKS

Line	Item Number	UM	Qty	Quote #
2700	406875	EA	2298	370610

**406875 PINE LF XJB 6 7/16" MULT**

cut 6 pcs 3-5, 56 pcs 4-6, 87 pcs 5-0, 4 pcs 6-6, 28 pcs 7-0 24 pcs 7-6, 48 pcs 8-0 48 pcs 8-6 24 9-0 & 18 pcs 10-0

Line	Item Number	UM	Qty	Quote #
2800	406876	EA	40	370610

**406876 PINE 1/2C XJB 6 7/16" 5026 HCIRC**

Line	Item Number	UM	Qty	Quote #
2900	406877	EA	9	370610

**406877 PINE 1/2C XJB 6 7/16" 4-10 X 2 -5 HCIRC**

Quote # 370610

Hackney Replacement

<b>Selling Price</b>	\$232 621 00
<b>Labor</b>	\$0.00
<b>Freight</b>	\$0.00
<b>Sales Tax</b>	\$21,517 45
<b>Total Quote</b>	\$254 138 40

**Disclaimer**

STANDARD OPTIONS AT NO UPCHARGE  
54 STANDARD COLORS  
UNPRIMED OR PRIMED  
EAGLE VISION GUARD  
LOW-E MAXIMIZER PLUS OR SUN 145 GLASS STANDARD

PLEASE READ QUOTE AND CHECK ALL WINDOW SIZES, EGRESS WINDOWS AND FOR TEMPERED GLASS AS NEEDED IT IS THE RESPONSIBILITY OF THE BUILDER TO CHECK ALL LOCAL BUILDING CODES IN HIS AREA. THIS IS A CUSTOM WINDOW ORDER AND NO RETURNS ARE ALLOWED

SIGNATURE \_\_\_\_\_ DATE \_\_\_\_\_

ALL SIZES QUOTED ARE ESTIMATED AND WILL BE FIELD VERIFIED BEFORE ORDERING

FRAME EXPANDER METAL IS NOT INCLUDED IN THIS QUOTE. SIZE AND QUANTITY (IF REQUIRED) WILL BE DETERMINED DURING FIELD VERIFICATION OF ACTUAL SIZES NEEDED.

# Gay Street Facade



# State Street Facade



These windows were replaced about 3 years ago with the same brand and type of window that will be used for the rest of the building.

# Union Ave Facade

Rear (near State)



Front (near Gay)



Middle

