

# Report of Staff Recommendation

Tennessee Technology Corridor Development Authority

File Number:

9-A-20-TOS

**Applicant:** SYCAMORE SIGN SERVICE

**Request:** SIGN PERMIT

**Meeting Date:** 9/8/2020

---

**Address:** 10620 Kemp Fain Ln.

**Map/Parcel Number:** 103 E A 013

**Location:** Southeast side Kemp Fain Lane, east of Cherahala Blvd.

**Existing Zoning:** BP (Business and Technology)/TO (Technology Overlay)

**Proposed Zoning:** N/A

**Existing Land Use:** Office

**Proposed Land Use:** ADT Offices

**Appx. Size of Tract:** 10.62 acres

**Accessibility:** Access is via Kemp Lane, a local street with 26 ft. of pavement, within a 65 ft. right-ofway.

**Surrounding Zoning and Land Uses:** North: BP (Business Park) - Vacant land

South: BP (Business Park) - Residences

East: BP (Business Park) - Residences

West: BP (Business Park) - Vacant land

---

**Comments:**

- 1) This is a request for two building signs at 10620 Kemp Fain Lane. The building formerly housed Brinks Home Security Systems, and building plans were approved by the TTCDA in 2005. The applicant will use the existing building and site as is. The building fronts Kemp Fain Lane, but the side of the building is visible from Cherahala Boulevard to the south. The signage is for ADT Security Systems.
- 2) The building frontage is approximately 238 linear feet, so 100 square feet is the maximum square footage allowed for building signage.
- 3) There are two signs proposed for the building; one will face Kemp Fain Lane and the other will face Cherahala Boulevard. Both signs are identical in design. They comprise 49 square feet each, for a total area of 98 square feet.
- 4) Each sign will be a 5" deep illuminated channel logo cabinet. The sign plans denote lexan panels for the flex face sign directly mounted to the building façade and internally lit with LED lighting.
- 5) The sign will be blue and white, utilizing the blue of the ADT logo.

---

**Design Guideline Conformity:** This request complies with the TTCDA Design Guidelines.

---

**Waivers and Variances Requested:** Not applicable.

---

**Staff Recommendation:** Based on the application and sign plans as submitted, staff recommends APPROVAL of a Certificate of Appropriateness for a sign permit, subject to the following condition:

1) Meeting all relevant requirements of the Knox County Zoning Ordinance, as appropriate.

---

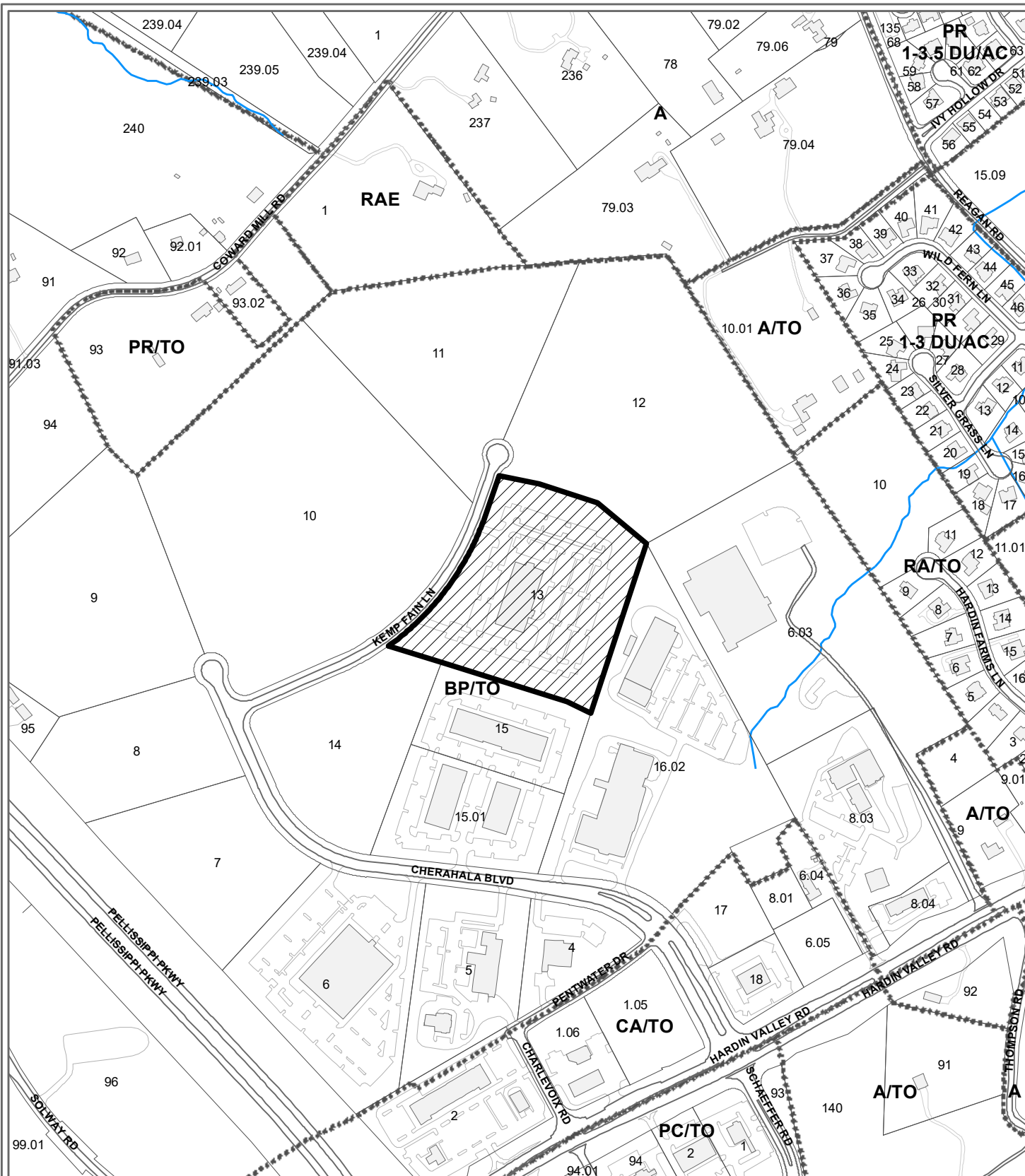

**9-A-20-TOS  
CERTIFICATE OF APPROPRIATENESS**



Purpose of Request: Signage

Original Print Date: 8/14/2020      Revised:  
Knoxville - Knox County Planning Commission \* City / County Building \* Knoxville, TN 37902

Petitioner: Sycamore Sign Service

Map No: 103

Jurisdiction: County

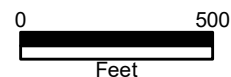



**Job Number: 71394**

**Sales Rep: JF**

**Designer: TB**

**June 24, 2019**

**10620 Kemp Fain Lane  
Knoxville, TN 37932**





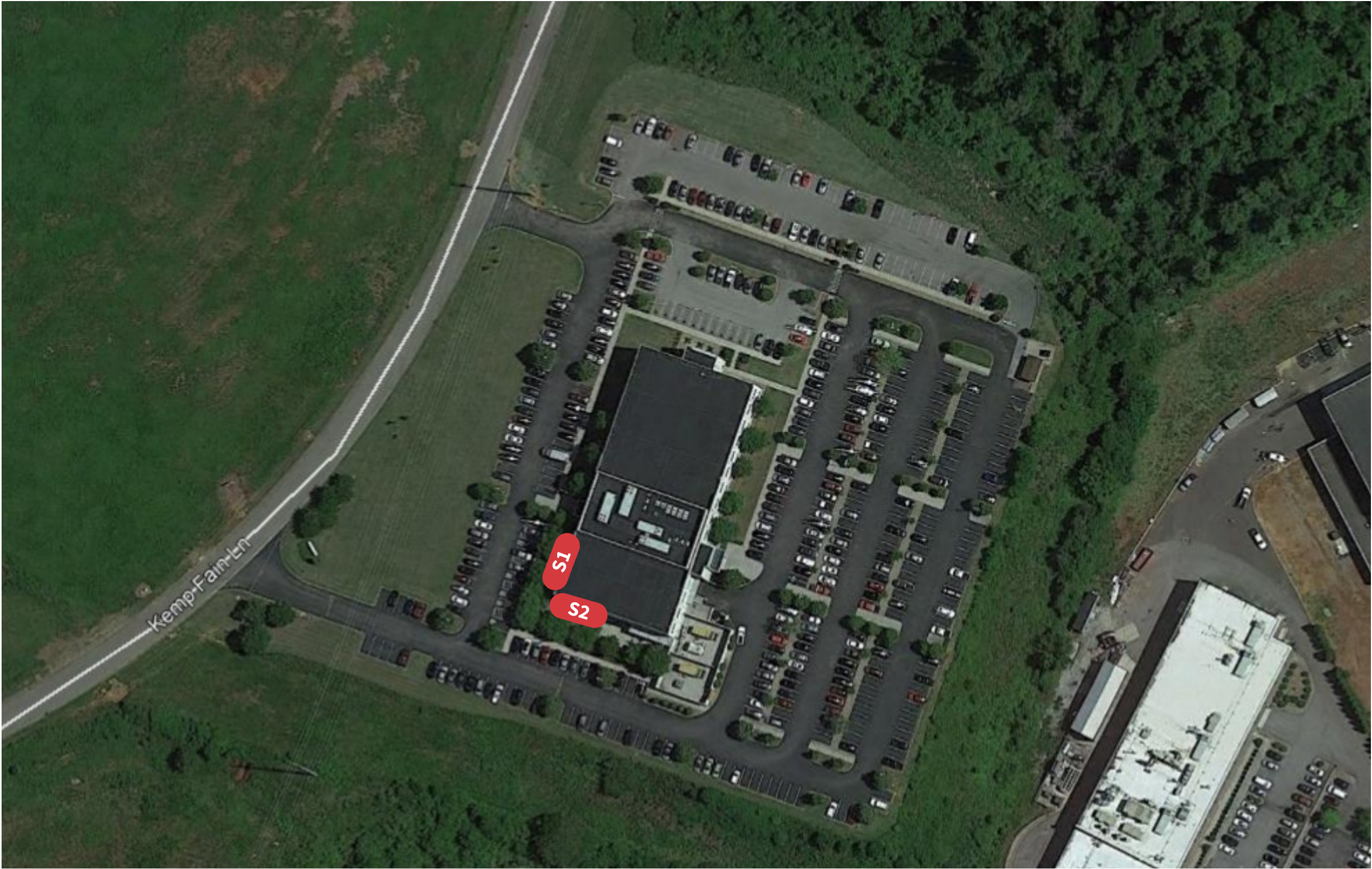

130 Commerce Road, Boynton Beach FL 33426 | (561) 547-3760  
327 New South Road, Hicksville NY 11801 | (631) 273-4800  
americansigncrafters.com

PROJECT



10620 Kemp Fain Lane, Knoxville, TN 37932

DATE

06.24.20

ACCOUNT  
EXECUTIVE

JF

PROJECT  
MANAGER

DM

DESIGNER

TB

REVISIONS

6.29.20 TB - Update S1 & S2 to Flex Face Bleed Frame  
8.27.20 BB - Update sign style/type

APPROVAL

- ☐ Approved  
☐ Approved as Noted  
☐ Revise & Resubmit

Approved:  
Date:

- ALL ELECTRICAL COMPONENTS ARE TO BE U.L. LISTED AND APPROVED AS PER THE NEC 2017
- ALL BALLAST, TRANSFORMERS, ELECTRONIC POWER SUPPLIES AND CLASS 2 POWER SOURCES TO COMPLY WITH NEC 600.21
- ALL PRIMARY WIRING TO BE #12 THWN AS PER NEC-40-5
- GROUNDING & BONDING AS PER NEC 250
- INSTALLATION WILL COMPLY WITH ALL OF THE REQUIREMENTS OF THE NEC 800 & FBC EC 405.2.4
- SIGNS WILL BE CONTROLLED BY A PHOTOCELL OR ASTRONOMICAL TIME CLOCK



JOB #

71394

PAGE

2

OF 5



**Scope of Work:** Manufacture and install (1) new ADT Sign.

- Logo Cabinet: Flex Face Bleed Frame, Face Lit
- Remote Power Supplies, placement Must be above the membrane of roof.
- Sign Band Dimensions: 98"h x 173"w

**NOTE:** Blue Flex and Returns must be a flat finish, city does not allow gloss finish.

**NOTE:** Client responsible for running primary electrical.

Color Reference Chart

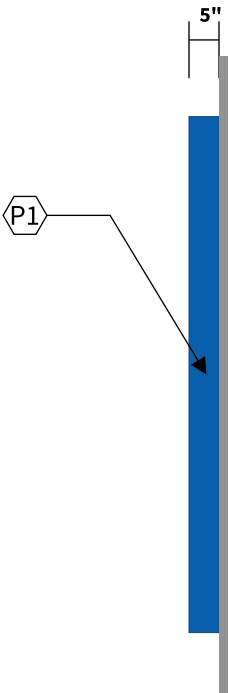
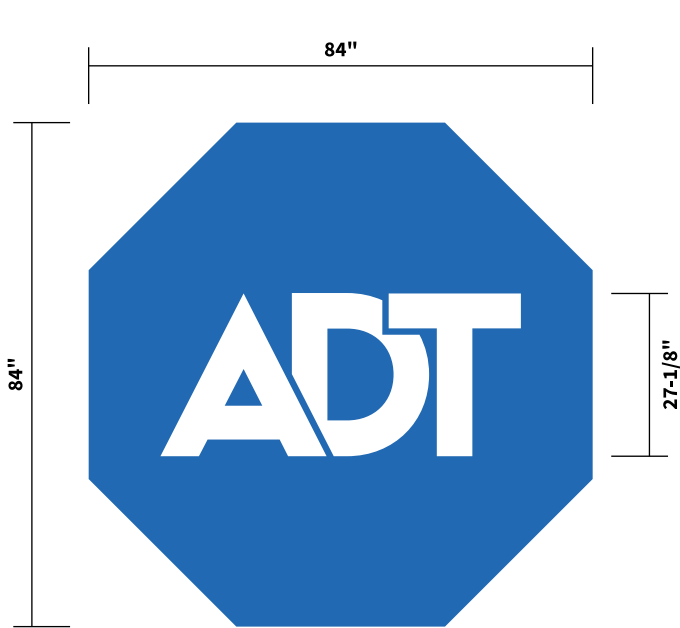
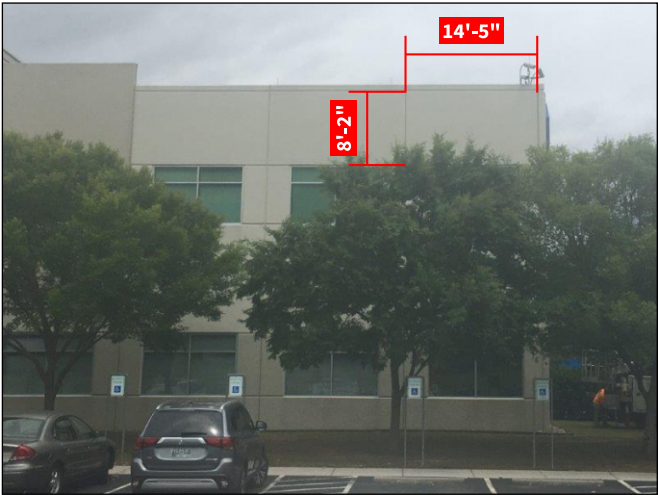
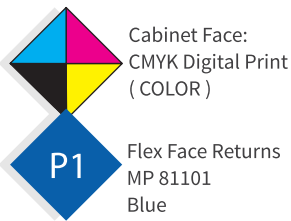

1 Front Elevation | Illuminated Channel Logo Cabinet  
Scale: 3/8"=1'-0"

2 End View  
Scale: 3/8"=1'-0"

- (1) Flat bleed retro frame cover part; Painted MP 81101 Blue
- (2) Cover screw
- (3) Tension clip
- (4) Flexible face material w/ digital print
- (5) Frame corner angle shot
- (6) Flat bleed retro frame
- (7) White led lighting strips mounted to clear Lexan panel per detail
- (8) Waterproof disconnect switch per NEC 600-6
- (9) M-volt power supply
- (10) Countersink metal fastener attaching retro frame to alum. Sign frame
- (11) 2x2" SQ. tube sign frame; outer edge painted White
- (12) 0.50" ø S.S. All threaded bolt, washers & nuts; Provided 1x blocking & penetration holes filled w/ clear silicone
- (13) Existing wall (TBC)
- (14) E.125" Thick Aluminum Backer Panel with welded Alum. returns, painted White

This sign is intended to be installed in accordance with the requirements of Article 600 of the National Electrical Code and/or other applicable local codes. This includes proper grounding and bonding of the sign.  
All components to be Approved

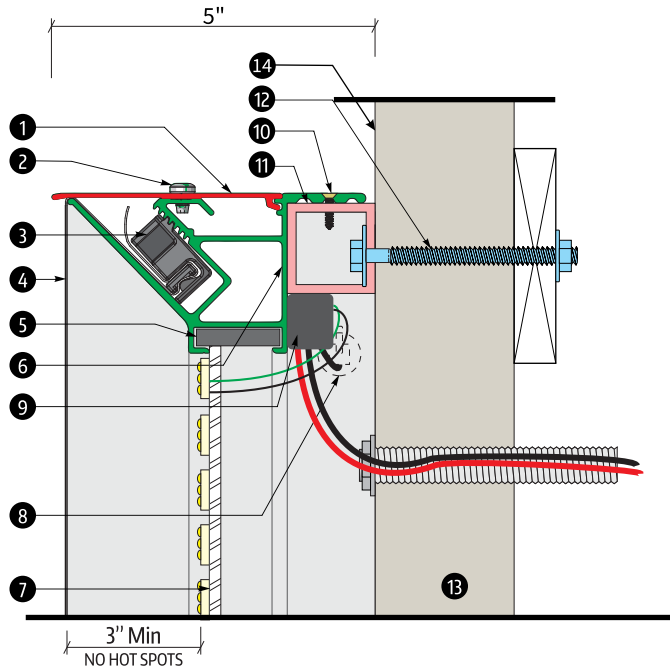

A Section Detail | Flex Face Sign w/ LED Illumination  
Scale: N.T.S



**AMERICAN / INTERSTATE  
SIGNCRAFTERS**

130 Commerce Road, Boynton Beach FL 33426 | (561) 547-3760  
327 New South Road, Hicksville NY 11801 | (631) 273-4800  
americansigncrafters.com

PROJECT



10620 Kemp Fain Lane, Knoxville, TN 37932

DATE 06.24.20

ACCOUNT EXECUTIVE JF

PROJECT MANAGER DM

DESIGNER TB

REVISIONS

6.29.20 TB - Update S1 & S2 to Flex Face Bleed Frame

8.27.20 BB - Update sign style/type

APPROVAL

☐ Approved

☐ Approved as Noted

☐ Revise & Resubmit

Approved: \_\_\_\_\_

Date: \_\_\_\_\_

- ALL ELECTRICAL COMPONENTS ARE TO BE U.L. LISTED AND APPROVED AS PER THE NEC 2017
- ALL BALLAST, TRANSFORMERS, ELECTRONIC POWER SUPPLIES AND CLASS 2 POWER SOURCES TO COMPLY WITH NEC 800.21
- ALL PRIMARY WIRING TO BE #12 THWN AS PER NEC-40-5
- GROUNDING & BONDING AS PER NEC 250
- INSTALLATION WILL COMPLY WITH ALL OF THE REQUIREMENTS OF THE NEC 800 & FBC EC 405.2.4
- SIGNS WILL BE CONTROLLED BY A PHOTOCELL OR ASTRONOMICAL TIME CLOCK



JOB # 71394

PAGE 3 OF 5

**Scope of Work:** Remove existing channel letters and pan, dispose offsite.  
Manufacture and install (1) new ADT Sign.  
- Logo Cabinet: Flex Face Bleed Frame, Face Lit  
- Remote Power Supplies, placement Must be above the membrane of roof.  
- Sign Band Dimensions: 98"h x 218"w

**NOTE:** Blue Flex and Returns must be a flat finish, city does not allow gloss finish.  
**NOTE:** Client responsible for running primary electrical.  
**NOTE:** Client responsible for wall repair.

Color Reference Chart

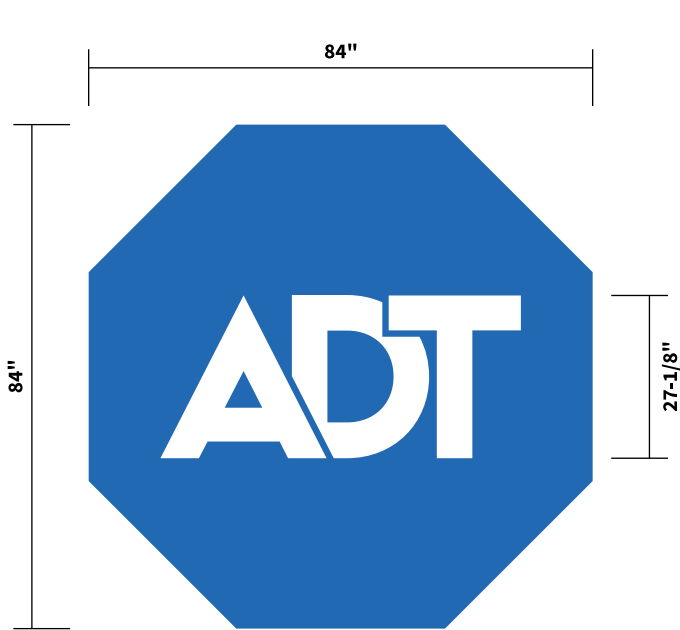
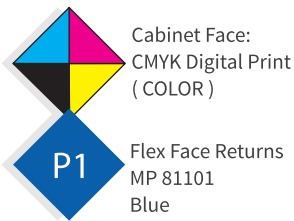

1 Front Elevation | Illuminated Channel Logo Cabinet  
Scale: 3/8"=1'-0"

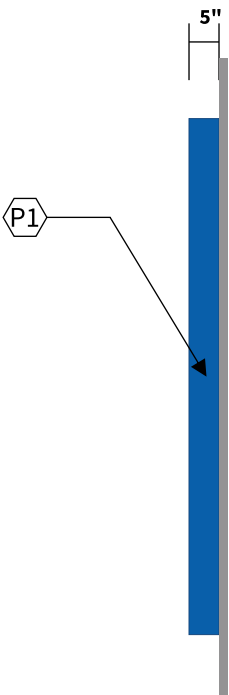

2 End View  
Scale: 3/8"=1'-0"

- (1) Flat bleed retro frame cover part; Painted MP 81101 Blue
- (2) Cover screw
- (3) Tension clip
- (4) Flexible face material w/ digital print
- (5) Frame corner angle shot
- (6) Flat bleed retro frame
- (7) White led lighting strips mounted to clear Lexan panel per detail
- (8) Waterproof disconnect switch per NEC 600-6
- (9) M-volt power supply
- (10) Countersink metal fastener attaching retro frame to alum. Sign frame
- (11) 2x2" SQ. tube sign frame; outer edge painted White
- (12) 0.50" ø S.S. All threaded bolt, washers & nuts; Provided 1x blocking & penetration holes filled w/ clear silicone
- (13) Existing wall (TBC)
- (14) E.125" Thick Aluminum Backer Panel with welded Alum. returns, painted White

This sign is intended to be installed in accordance with the requirements of Article 600 of the National Electrical Code and/or other applicable local codes. This includes proper grounding and bonding of the sign.  
All components to be Approved

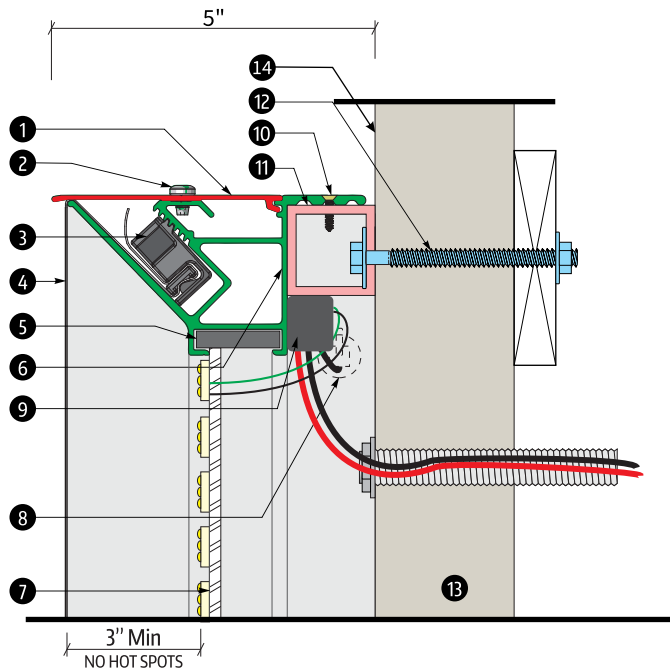

A Section Detail | Flex Face Sign w/ LED Illumination  
Scale: N.T.S

APPROVAL

- ☐ Approved
- ☐ Approved as Noted
- ☐ Revise & Resubmit

Approved:  
Date:

- ALL ELECTRICAL COMPONENTS ARE TO BE U.L. LISTED AND APPROVED AS PER THE NEC 2017
- ALL BALLAST, TRANSFORMERS, ELECTRONIC POWER SUPPLIES AND CLASS 2 POWER SOURCES TO COMPLY WITH NEC 600.21
- ALL PRIMARY WIRING TO BE #12 THWN AS PER NEC-40-5
- GROUNDING & BONDING AS PER NEC 250
- INSTALLATION WILL COMPLY WITH ALL OF THE REQUIREMENTS OF THE NEC 800 & FBC EC 405.2.4
- SIGNS WILL BE CONTROLLED BY A PHOTOCELL OR ASTRONOMICAL TIME CLOCK







Existing Sign on Pan Panel

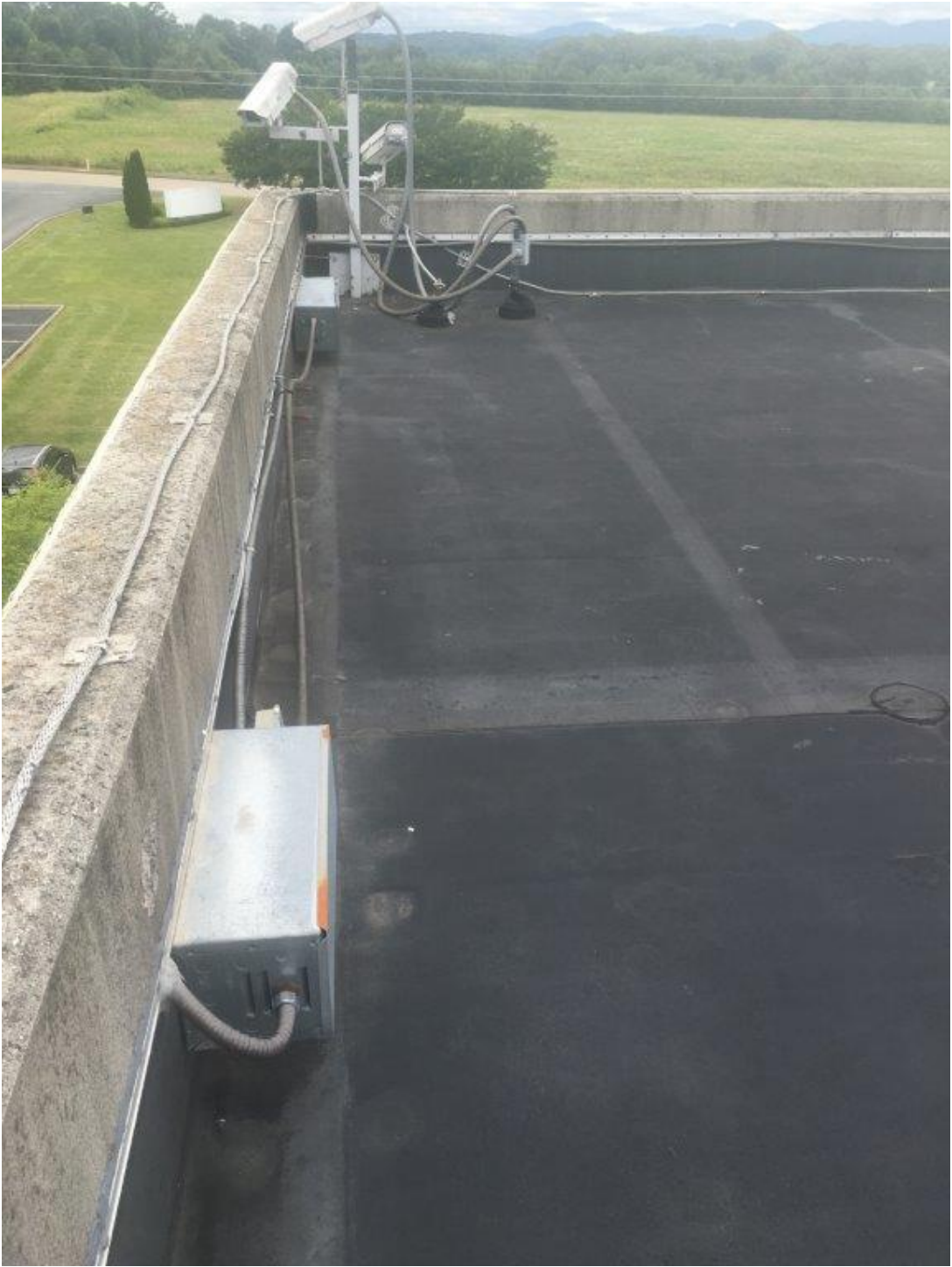

Power Supply Placement, Must be above the membrane roof as shown.



130 Commerce Road, Boynton Beach FL 33426 | (561) 547-3760  
327 New South Road, Hicksville NY 11801 | (631) 273-4800  
americansigncrafters.com

PROJECT



10620 Kemp Fain Lane, Knoxville, TN 37932

DATE

06.24.20

ACCOUNT EXECUTIVE

JF

PROJECT MANAGER

DM

DESIGNER

TB

REVISIONS

- 6.29.20 TB - Update S1 & S2 to Flex Face Bleed Frame
- 8.27.20 BB - Update sign style/type

APPROVAL

- ☐ Approved
- ☐ Approved as Noted
- ☐ Revise & Resubmit

Approved:  
Date:

- ALL ELECTRICAL COMPONENTS ARE TO BE UL LISTED AND APPROVED AS PER THE NEC 2017
- ALL BALLAST, TRANSFORMERS, ELECTRONIC POWER SUPPLIES AND CLASS 2 POWER SOURCES TO COMPLY WITH NEC 800.21
- ALL PRIMARY WIRING TO BE #12 THWN AS PER NEC-40-5
- GROUNDING & BONDING AS PER NEC 250
- INSTALLATION WILL COMPLY WITH ALL OF THE REQUIREMENTS OF THE NEC 800 & FBC EC 405.2.4
- SIGNS WILL BE CONTROLLED BY A PHOTOCELL OR ASTRONOMICAL TIME CLOCK



JOB #

71394

PAGE

5

OF 5





# CERTIFICATE OF APPROPRIATENESS

Name of Applicant: Sycamore Sign Service

Date Filed: 7/30/20 Fee Paid: \$175 File Number: 8-A-20-TOS

Map Number: 103 Zoning District: BP/TO

Jurisdiction: ☐ City \_\_\_\_\_ Councilmanic District ☒ County 6th Commission District

## PROPERTY INFORMATION

ADDRESS: 10620 Kemp Fain Lane

STREET NUMBER AND NAME

GENERAL LOCATION: Southeast side of Kemp Fain Lane off of Cherahala Blvd., east of Pellissippi Pkwy.

PARCEL NUMBER(S): 103EA013

SIZE OF TRACT: 10.62 ☒ ACRES ☐ SQUARE FEET

## PURPOSE OF REQUEST

- ☐ BUILDING PERMIT — New Construction  
☐ BUILDING PERMIT — Expansion or Renovation  
☐ BUILDING PERMIT — Grading Plan  
☐ REZONING

From: \_\_\_\_\_

To: \_\_\_\_\_

- ☒ SIGNAGE  
☐ ZONING VARIANCE — (Describe and give reason)

NOTE: Four (4) copies of all plan materials are required to process the application. Please check all that apply:

- ☐ DEVELOPMENT PLAN  
☐ BUILDING ELEVATIONS  
☐ FLOOR PLAN  
☐ LANDSCAPE PLAN WITH SCHEDULE  
☒ SIGNAGE PLAN  
☐ OFF-STREET PARKING PLAN  
☐ OTHER:

## APPLICATION CORRESPONDENCE — All correspondence relating to this application should be sent to:

PLEASE PRINT

Name: Sherrie Bowers / Sycamore Sign Service Phone: 865-247-0466 Fax: 866-935-9597

Mailing Address: 3315 Riverside Drive Knoxville, TN 37914

## APPLICATION AUTHORIZATION — I hereby certify that I am the authorized applicant, representing ALL property owners involved in this request or holders of option on same, whose signatures are included on the back of this form.

Signature: Sherrie Bowers

PLEASE PRINT

Name: Sherrie Bowers Phone: 865-247-0466 Fax: 866-935-9597

Mailing Address: 3315 Riverside Drive Knoxville, TN 37914

## APPLICATION ACCEPTANCE — Staff Member who accepted this application: Michelle Portier

Michelle Portier



**SIGNATURES OF ALL PROPERTY OWNERS INVOLVED OR HOLDERS OF OPTION ON SAME MUST BE LISTED BELOW:**

(Please sign in black or blue ink)

NAME \_\_\_\_\_

Complete Mailing Address

Owner	Option
1	1
2	2
3	3
4	4
5	5
6	6
7	7
8	8
9	9
10	10
11	11
12	12
13	13
14	14
15	15
16	16
17	17
18	18
19	19
20	20
21	21
22	22
23	23
24	24
25	25
26	26
27	27
28	28
29	29
30	30
31	31
32	32
33	33
34	34
35	35
36	36
37	37
38	38
39	39
40	40
41	41
42	42
43	43
44	44
45	45
46	46
47	47
48	48
49	49
50	50
51	51
52	52
53	53
54	54
55	55
56	56
57	57
58	58
59	59
60	60
61	61
62	62
63	63
64	64
65	65
66	66
67	67
68	68
69	69
70	70
71	71
72	72
73	73
74	74
75	75
76	76
77	77
78	78
79	79
80	80
81	81
82	82
83	83
84	84
85	85
86	86
87	87
88	88
89	89
90	90
91	91
92	92
93	93
94	94
95	95
96	96
97	97
98	98
99	99
100	100

Judy Setayesh Owner's Representative. ADT. LLC  
1501 Yamato Road  
Boca Raton, FL 33431