



TENNESSEE TECHNOLOGY CORRIDOR DEVELOPMENT AUTHORITY

REPORT OF STAFF RECOMMENDATION

Meeting Date: 5/6/2019
File Number: 5-E-19-TOS
Applicant: TONY SAFFLES
Request: SIGN PERMIT

Address: 2360 Cherahala Blvd
Map/Parcel Number: 103 E A 01602
Location: Northeast side of Cherahala Boulevard, north of Pentwater Drive.
Existing Zoning: BP (Business and Technology) / TO (Technology Overlay)
Proposed Zoning: NA
Existing Land Use: Business
Proposed Land Use: Replace yard and building signage
Appx. Size of Tract: 15.17 acres
Accessibility: Access is via Cherahala Blvd., a local street that serves the Pellissippi Corporate Center.
Surrounding Zoning and Land Uses:
North: BP (Business and Technology) / TO (Technology Overlay) - Business and vacant land.
South: CA (General Business) / TO (Technology Overlay) - Restaurants and vacant land.
East: BP (Business and Technology) / TO (Technology Overlay) - Businesses
West: BP (Business and Technology) / TO (Technology Overlay) - Businesses

Comments: 1) This is a request to change the building and yard signs for the site located at 2360 Cherahala Blvd. that has been identified as the National Transportation and Research Center (NTRC).
2) The existing building sign for NTRC that is located above the main entrance for the facility will be replaced by a sign for Oak Ridge National Laboratory (ORNL). The sign area will be 98 square feet. A second building sign will be added to the building façade on the right side of the entrance for The University of Tennessee (UT). The sign area for the UT sign will be 29 square feet. With a building frontage of 198 feet, the two building signs comply with the Design Guidelines. The signs will include a brushed aluminum logo and individual letters that will be mounted directly to the brick wall. There is no lighting proposed for the signs.
3) The sign panel on the existing yard sign will also be modified to identify this site as the Hardin Valley Campus with both ORNL and UT as tenants. The sign will be vinyl letters applied to the brushed aluminum panel. The yard sign is a single sided sign with a sign area of 24.92 square feet which is within the 100 square foot maximum sign area allowed by the Design Guidelines. The colors used for the sign include green, black and orange.

Design Guideline Conformity: This request complies with the TTCDA Design Guidelines.

Waivers and Variances Requested: Not applicable at this time.

Staff Recommendation:

Based on the application and elevation as submitted, the staff recommends APPROVAL of a Certificate of Appropriateness for a Sign Permit, subject to the following condition:

- 1) Meeting all relevant requirements of the Knoxville Zoning Ordinance, as appropriate.

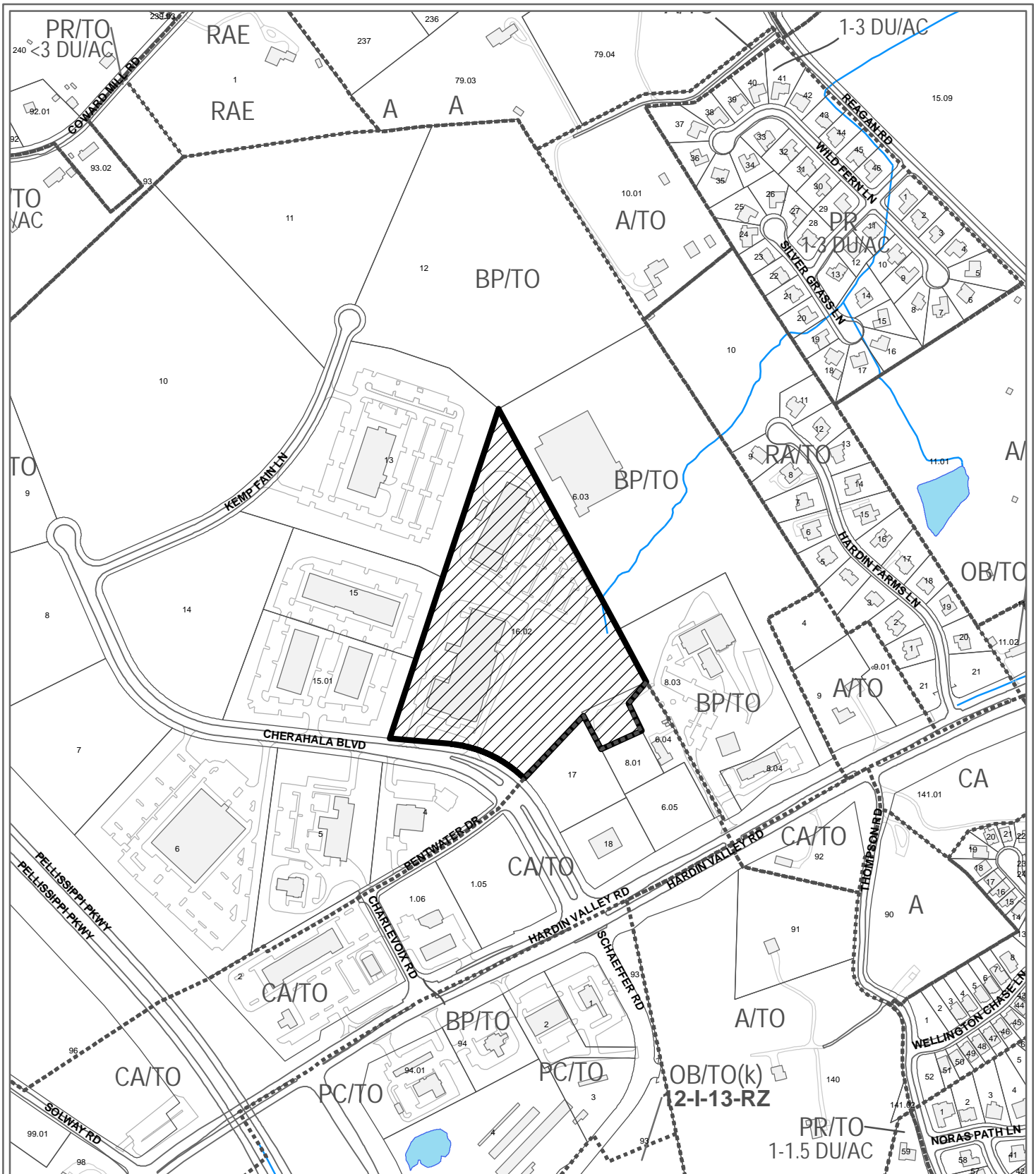

**5-E-19-TOS
CERTIFICATE OF APPROPRIATENESS**



Purpose of Request: Signage

Petitioner: Saffles, Tony

Map No: 103

Jurisdiction: County

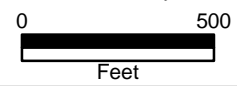

Original Print Date: 4/25/2019 Revised:
Metropolitan Planning Commission * City / County Building * Knoxville, TN 37902



EXISTING

This design is the exclusive and confidential property of Neon Service Company. It is not to be used, reproduced, copied or exhibited in any fashion without the written permission of Neon Service Company. All rights reserved. The value of this design is \$_____

5-E-19-TOS

<i>Neon Service Co.</i>		
SCALE:	APPROVED BY:	DRAWN BY:
DATE: 4-5-19		S. M.
NAME: ORNL UT Building & Monument Signs		
DRAWING NUMBER		4-5-194213

98 Total Sq. Ft.

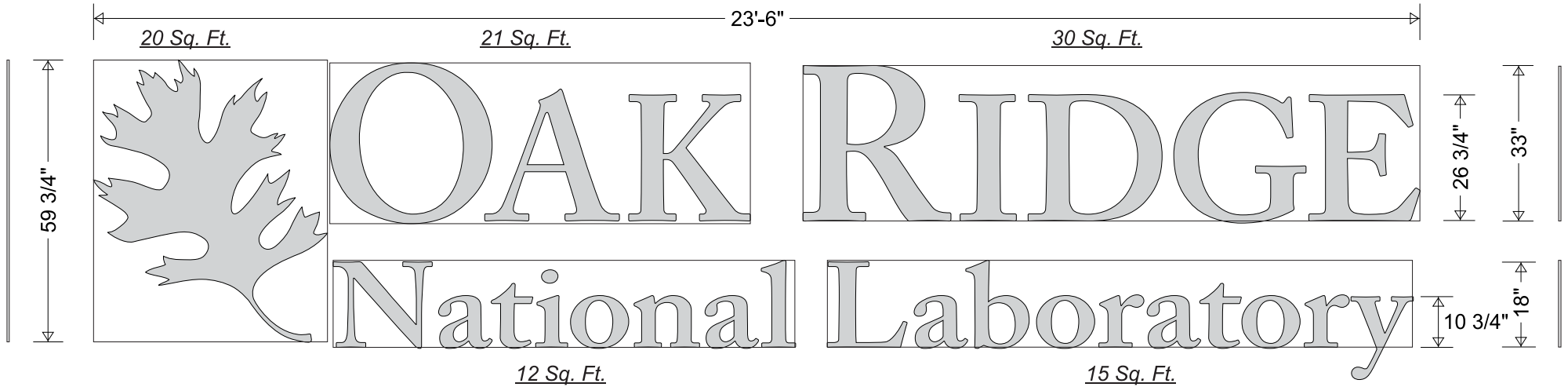

*NOTE: One (1) set of letters cut from 1/2"
Brushed aluminum with horizontal grain.
All to be stud mounted on brick wall.*

This design is the exclusive and confidential property of Neon Service Company. It is not to be used, reproduced, copied or exhibited in any fashion without the written permission of Neon Service Company. All rights reserved. The value of this design is \$_____

5-E-19-TOS

<i>Neon Service Co.</i>		
SCALE: 3/8" = 1'	APPROVED BY:	DRAWN BY:
DATE: 4-29-19		S. M.
NAME: ORNL UT Building & Monument Signs		
DRAWING NUMBER		4-5-194213-2

29 Total Sq. Ft.

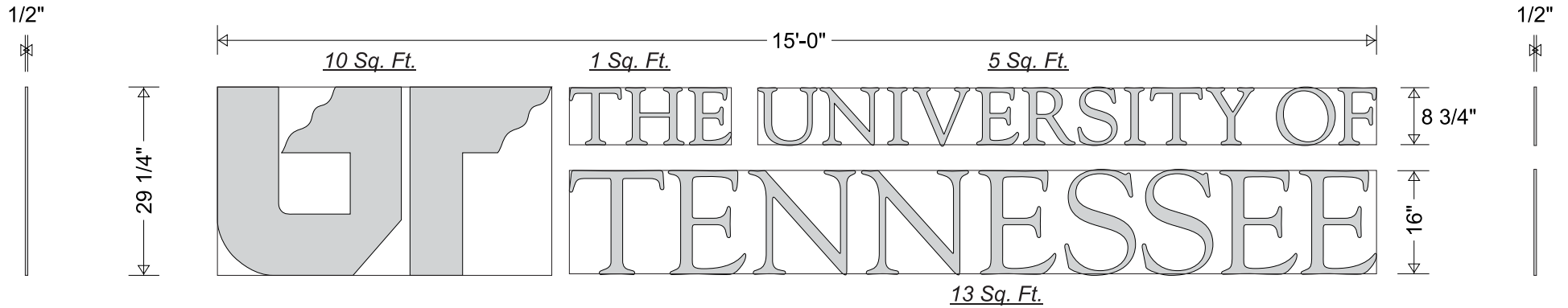

*NOTE: One (1) set of letters cut from 1/2"
Brushed aluminum with horizontal grain.
All to be stud mounted on brick wall.*

This design is the exclusive and confidential property of Neon Service Company. It is not to be used, reproduced, copied or exhibited in any fashion without the written permission of Neon Service Company. All rights reserved. The value of this design is \$_____

5-E-19-TOS

<i>Neon Service Co.</i>		
SCALE: 1/2" = 1'	APPROVED BY:	DRAWN BY:
DATE: 4-29-19		S. M.
NAME: ORNL UT Building & Monument Signs		
DRAWING NUMBER		4-5-194213-2

NOTE: One (1) set of laser cut 3/8" acrylic letters and logo painted PMS 356 Green and stud mounted on existing monument sign.



Hardin Valley Campus



Vinyl

This design is the exclusive and confidential property of Neon Service Company. It is not to be used, reproduced, copied or exhibited in any fashion without the written permission of Neon Service Company. All rights reserved. The value of this design is \$_____

NOTE: One (1) set of premium vinyl applied to existing monument sign.

5-E-19-TOS

<i>Neon Service Co.</i>		
SCALE: 1 1/2" = 1'	APPROVED BY:	DRAWN BY:
DATE: 4-29-19		S. M.
NAME: ORNL UT Building & Monument Signs		
DRAWING NUMBER		4-5-194213-2

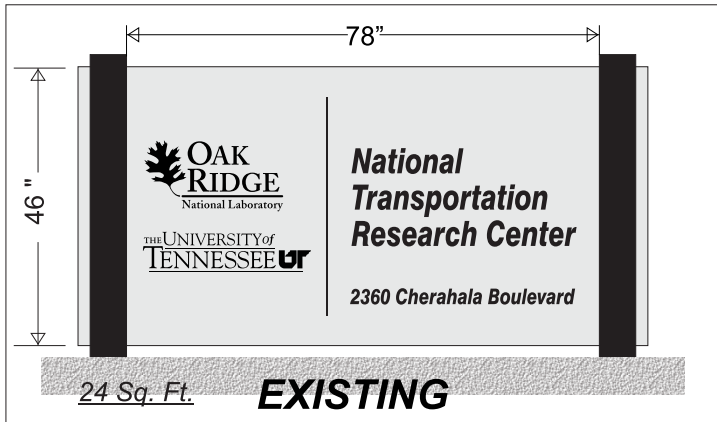

NEW PROPOSED

This design is the exclusive and confidential property of Neon Service Company. It is not to be used, reproduced, copied or exhibited in any fashion without the written permission of Neon Service Company. All rights reserved. The value of this design is \$_____

5-E-19-TOS

<i>Neon Service Co.</i>		
SCALE: 1/2" = 1'	APPROVED BY:	DRAWN BY:
DATE: 4-29-19		S. M.
NAME: ORNL UT Building & Monument Signs		
DRAWING NUMBER		4-5-194213-2