



TENNESSEE TECHNOLOGY CORRIDOR DEVELOPMENT AUTHORITY

REPORT OF STAFF RECOMMENDATION

Meeting Date: 5/6/2019
File Number: 5-B-19-TOS
Applicant: SIGNARAMA KNOXVILLE - JONATHAN FLENNIKEN
Request: SIGN PERMIT

Address: 504 Carden Jennings Ln
Map/Parcel Number: 131 G A 00805
Location: South end of Carden Jennings Lane, north side of I40 / I75.
Existing Zoning: CB (Business and Manufacturing) / TO (Technology Overlay)
Proposed Zoning: NA
Existing Land Use: Mixed businesses
Proposed Land Use: Building signs
Appx. Size of Tract: 3.66 acres
Accessibility: Access is via Carden Jennings Lane, a private local street with a 26' pavement width within a 50' private right-of-way.
Surrounding Zoning and Land Uses:
North: CB (Business and Manufacturing) / TO (Technology Overlay) - Businesses
South: PC-2 (Retail and Distribution Park) / TO-1 (Technology Overlay) - I40 / I75
East: C-6 (General Commercial Park) / TO-1 (Technology Overlay) - Storage yard
West: CB (Business and Manufacturing) / TO (Technology Overlay) & C-6 (General Commercial Park) / TO-1 (Technology Overlay) - Vacant lot and businesses

Comments: 1) This is a request to add two building signs for American Concrete Concepts at a multi-tenant commercial development located at the south end of Carden Jennings Lane of Lexington Drive. The building also fronts on I40 / I75.
2) The main entrance for the business faces I40 / I75. The sign will be affixed to the building façade above the tenant space which is located at the center of the eastern building fronting the road. The sign will have a sign area of 24 square feet which is within the maximum allowable area of 25 square feet, based on the leased building frontage of 25 feet.
3) A second building sign of approximately 4.5 square feet will be located on the Carden Jennings Lane frontage above the service entrance.
4) The building signs include the business name and logo using two colors (black and blue) on a white background. The signs will not be illuminated.

Design Guideline Conformity: This request complies with the TTCDA Design Guidelines.

Waivers and Variances Requested: Not applicable at this time.

Staff Recommendation:

Based on the application and elevation as submitted, the staff recommends APPROVAL of a Certificate of Appropriateness for a Sign Permit, subject to the following condition:

1) Meeting all relevant requirements of the Knoxville Zoning Ordinance, as appropriate.

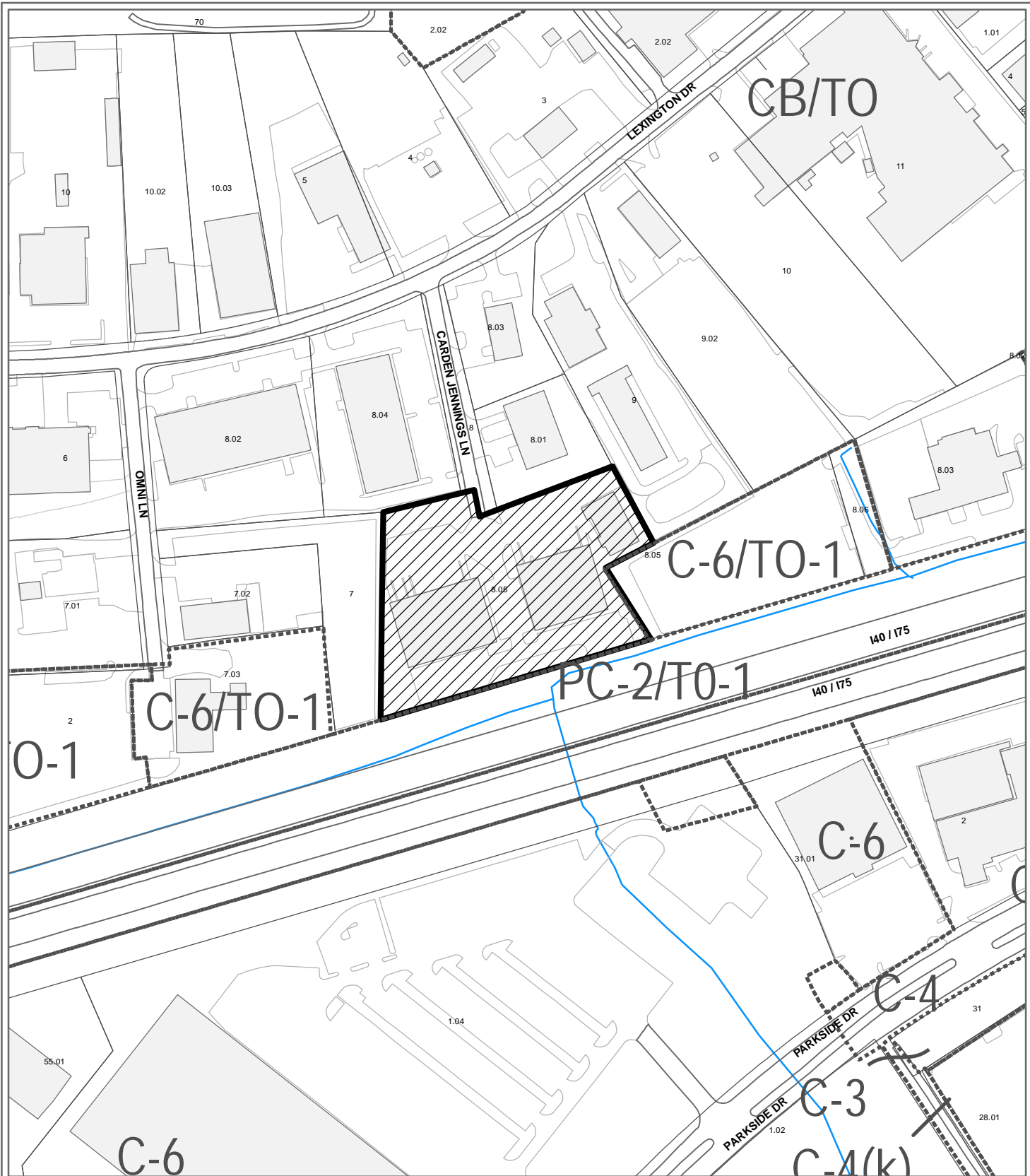

**5-B-19-TOS
CERTIFICATE OF APPROPRIATENESS**

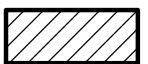

Purpose of Request: Signage

Original Print Date: 4/25/2019 Revised:
 Metropolitan Planning Commission * City / County Building * Knoxville, TN 37902

Petitioner: Signarama Knoxville - Jonathan Flenniken

Map No: 131

Jurisdiction: County

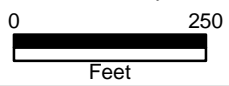

25 ft

14 ft

96 in

36 in



Andersen

5-B-19-TOS





25 ft

10 ft

NOTICE
24 HOUR VIDEO
SURVEILLANCE

36 in.
18 in.
AMERICAN
CONCRETE

5-B-19-TOS

